

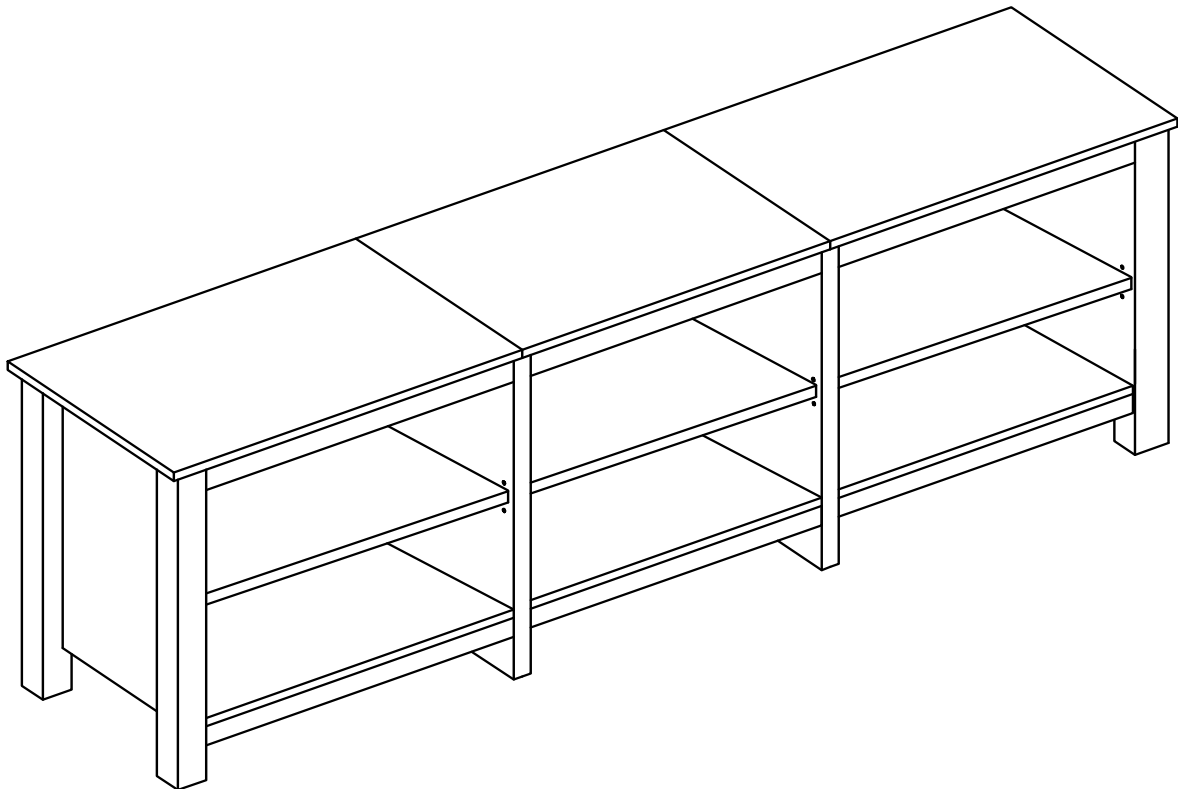

USE AND CARE GUIDE

70INCH COMBINABLE TV STAND



Questions, problems, assembly help, missing parts?

We will gladly help and ship your replacement parts free of charge.

If you have any question related to product please free to contact our customer
service mail: Rockpointservice@hotmail.com

All the detail Assembly issue pls review the website: www.HiRockpoint.com

IMPORTANT

THIS INSTRUCTION CONTAINS IMPORTANT SAFETY INFORMATION.
PLEASE READ AND KEEP FOR FUTURE REFERENCE



WARNING

- Do not allow children to climb on unit
- Serious or fatal crushing injuries can occur from furniture tip-over, To prevent this furniture from tipping over it must be permanently fixed to the wall.
- Fixing devices for the wall are not included since different wall materials require different types of fixing devices. Use fixing devices suitable for the walls in your home. For advice on suitable fixing systems, contact your local specialized dealer
- This unit contains small parts which can be swallowed by children and pets. Keep children and pets away during assembly. To avoid danger of suffocation, always keep plastic bags away from children and pets.

BEFORE YOU START

- Separate and count all parts and hardware.
- Have the following tools: Flat head Screwdriver, #2 Philips Head Screwdriver.
- If using a power tools, please be ware to slow down and stop when screw is tight. Failure to do so may result in stripping the screw.
- Requires two people for assembly.

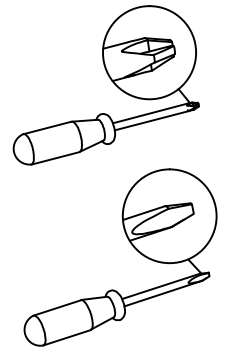

CAM LOCK FASTENING SYSTEM

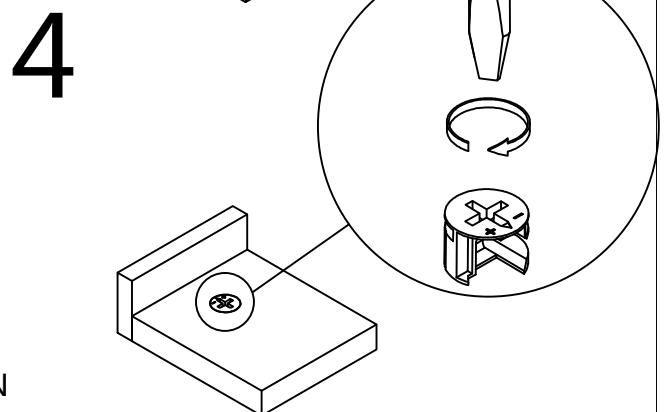
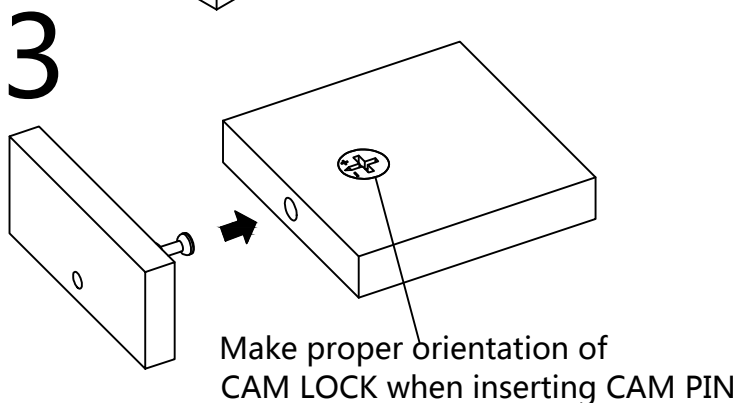
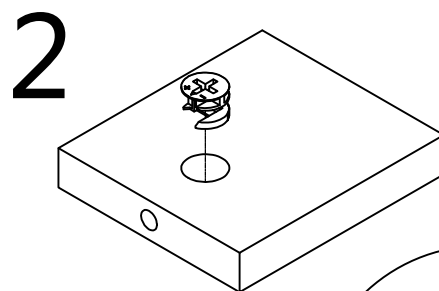
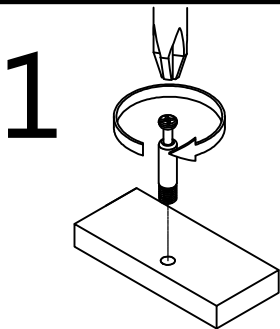

BOARD IDENTIFICATION

NOT SHOW ACTUAL SIZE

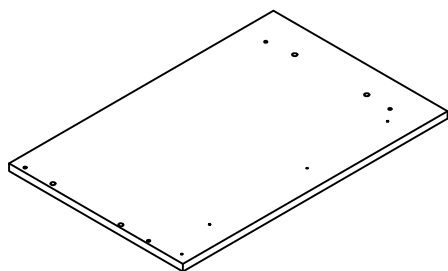

A

LEFT TOP PANEL
X1

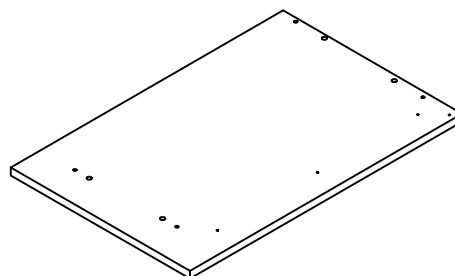

B

RIGHT TOP PANEL
X1

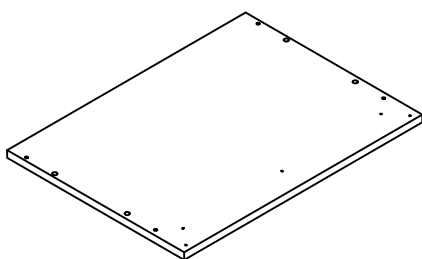

C

MIDDLE TOP PANEL
X1

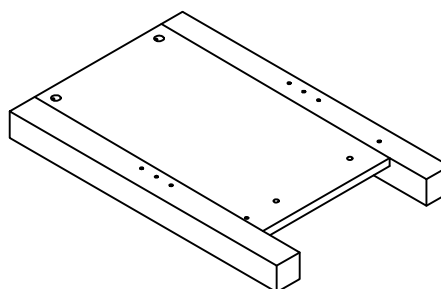

D

LEFT SIDE PANEL
X1

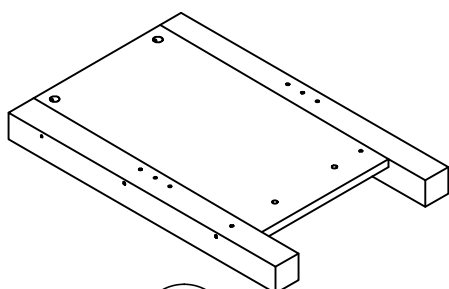

E

RIGHT SIDE PANEL
X1

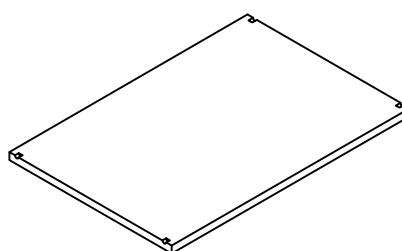

F

SIDE SHELF PANEL
X2

BOARD IDENTIFICATION

NOT SHOW ACTUAL SIZE

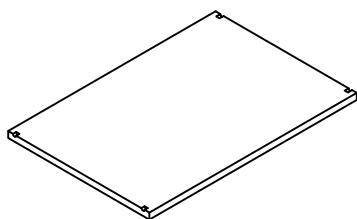

G

MIDDLE SHELF PANEL
X1

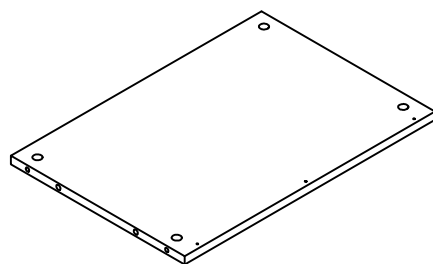

H

SIDE BOTTOM PANEL
X2

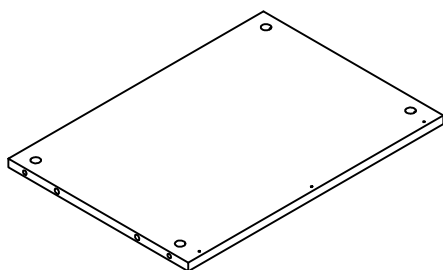

I

MIDDLE BOTTOM PANEL
X1

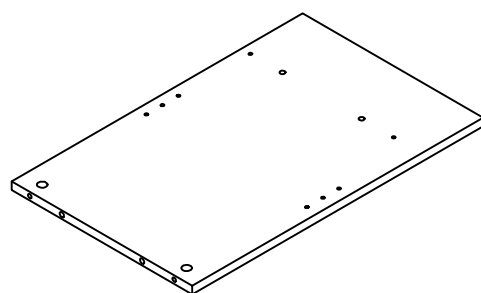

J

MID- LEFT-PARTITION
X1

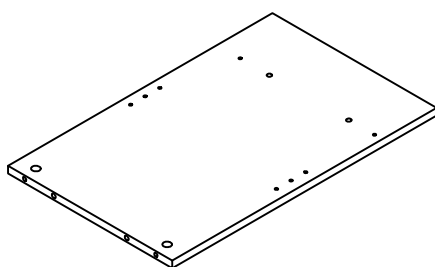

K

MID-RIGHT-PARTITION
X1

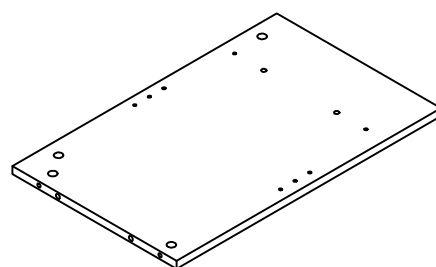

L

SID-LEFT-PARTITION
X1

BOARD IDENTIFICATION

NOT SHOW ACTUAL SIZE

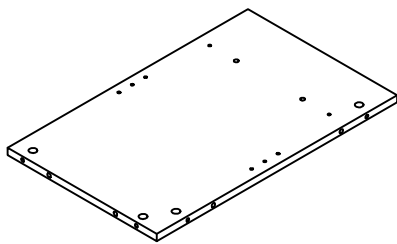

M

SID-RIGHT-PARTITION
X1

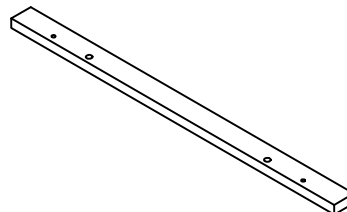

N

FRONT-PARTITION PANEL
X2

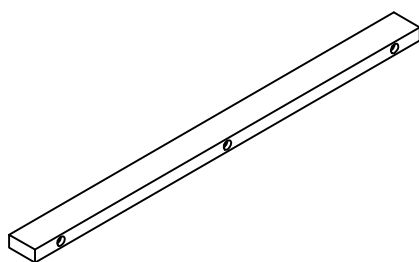

O

SIDE RAIL PANEL
X4

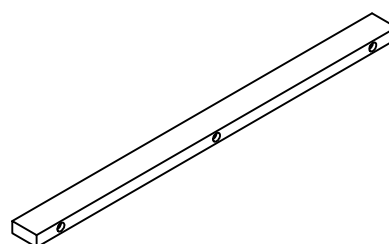

P

MIDDLE RAIL PANEL
X2

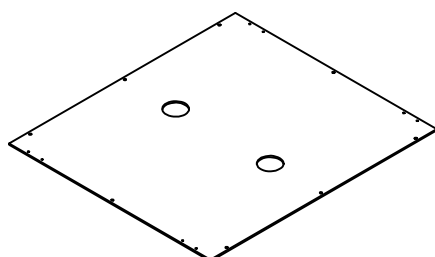

Q

MIDDLE BACK PANEL
X1

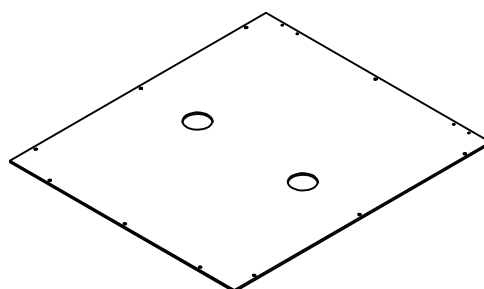

R

SIDE BACK PANEL
X2

HARDWARE PART LIST

NOT SHOW ACTUAL SIZE

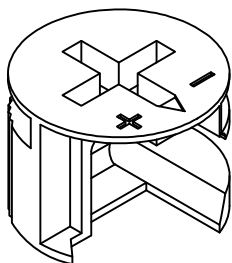

①X28

CAM LOCK

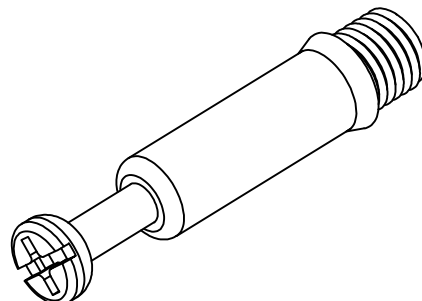

②X28

CAM PIN

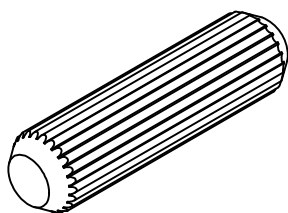

③X28

WOOD DOWEL

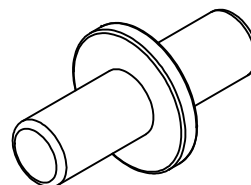

④X12

SHELF SUPPORT

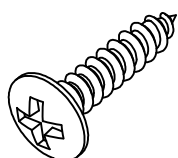

⑤X48

SCREW $\phi 3 \times 14$

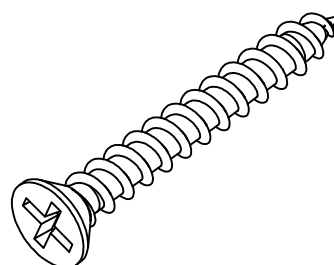

⑥X18

SCREW $\phi 4 \times 40$

HARDWARE PART LIST

NOT SHOW ACTUAL SIZE

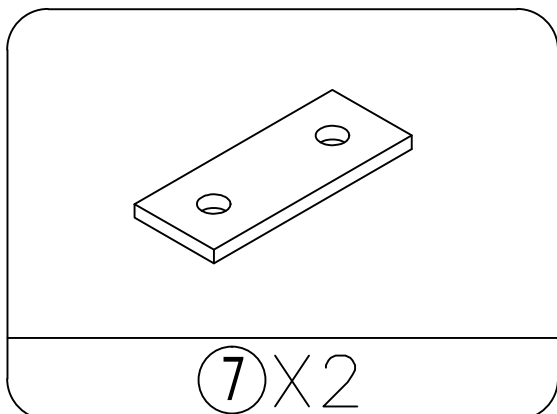

HOLRER PIECE

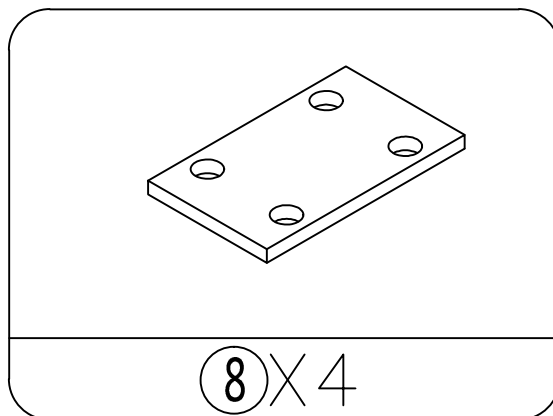

HOLRER PIECE

BOARD IDENTIFICATION

NOT SHOW ACTUAL SIZE

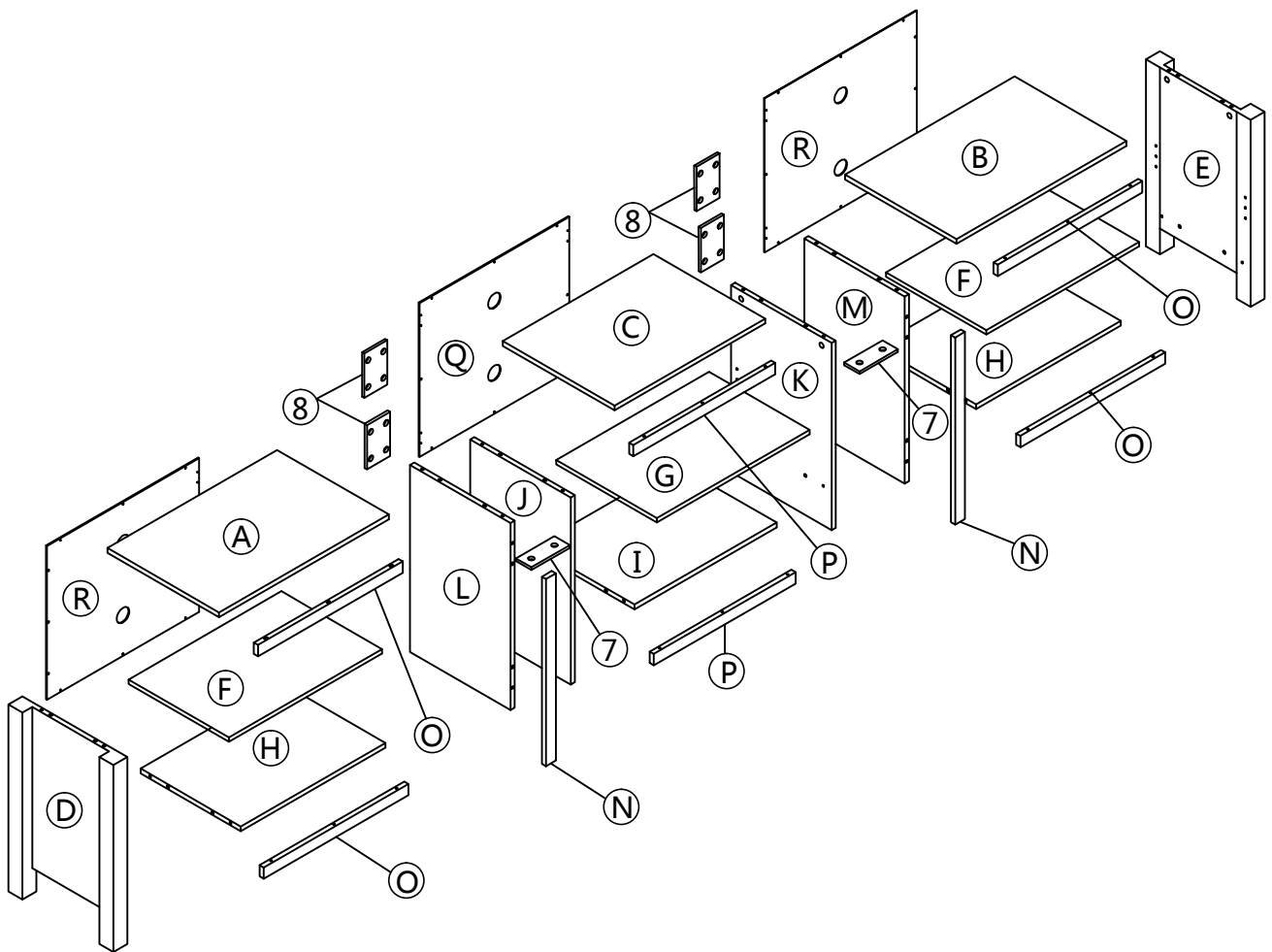

NOTICE

This product is combinable cabinet .Please read the content before assembly:

1、 If you want to use three cabinets separately. Please follow the steps 1 to 20 assemble them.

1、 If you want to assemble two cabinets on the side and use them together.And the middle cabinet to be used separately.Please follow the steps 1 to 25 assemble them.

1、 If you want to assemble three cabinets together.Please follow the steps 1 to 20 and steps 26 to 30 assemble them.

STEP 1

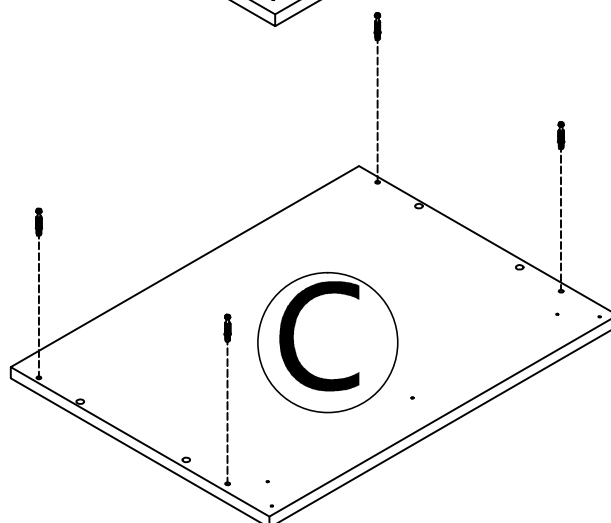
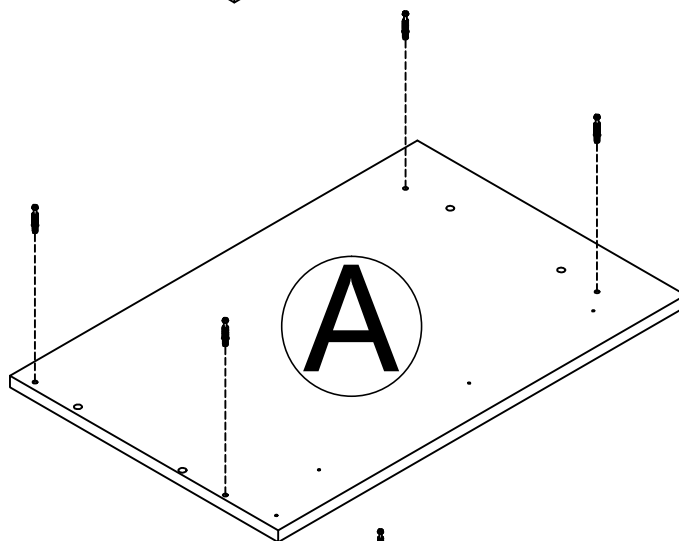
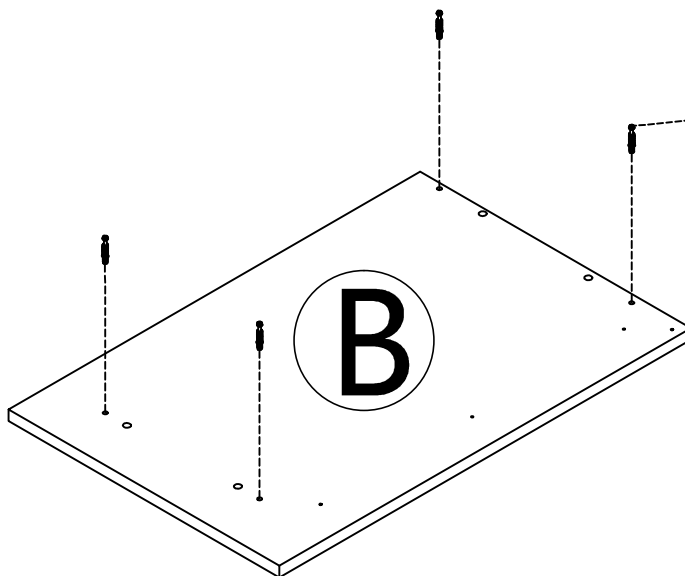
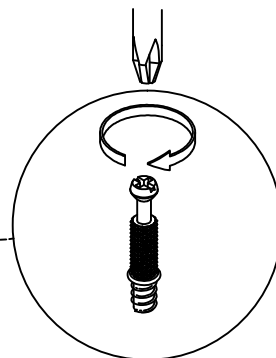
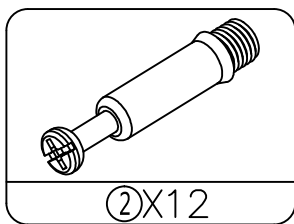

STEP 2

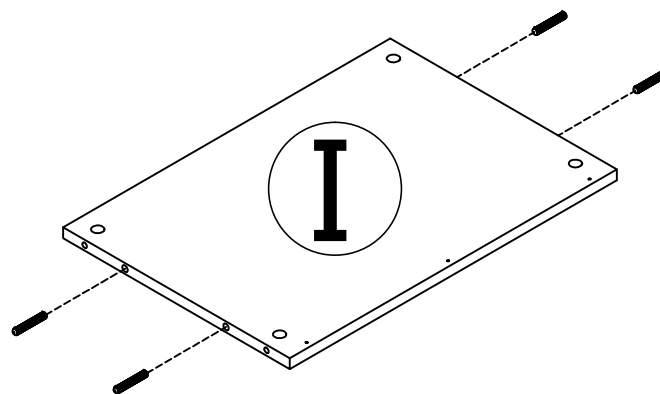
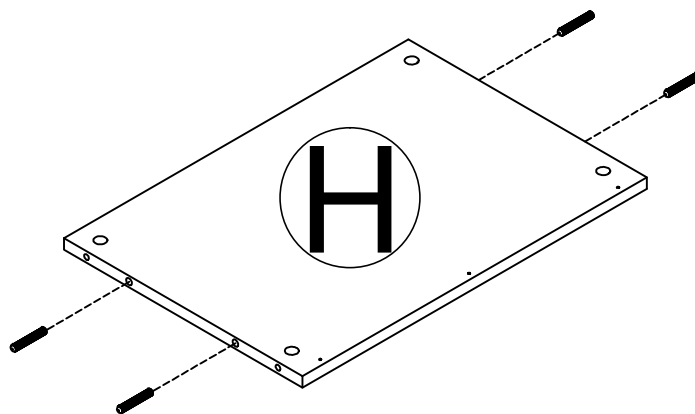
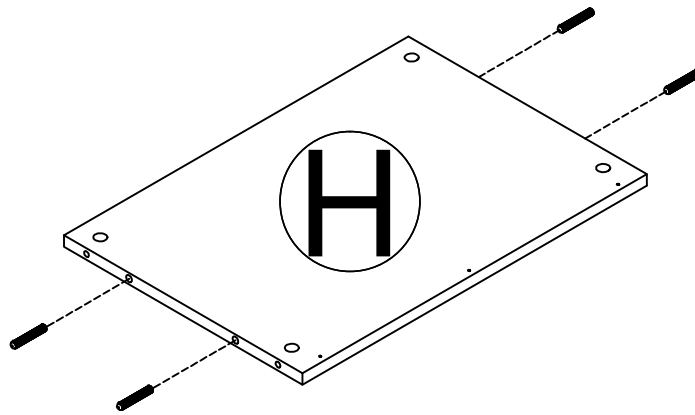
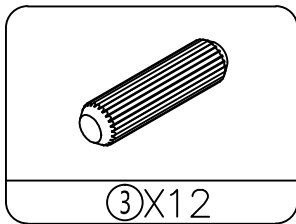

STEP 3

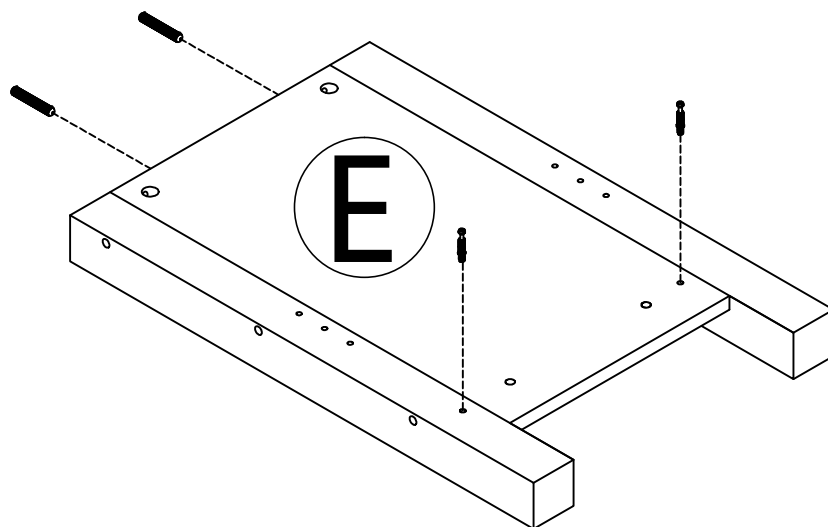
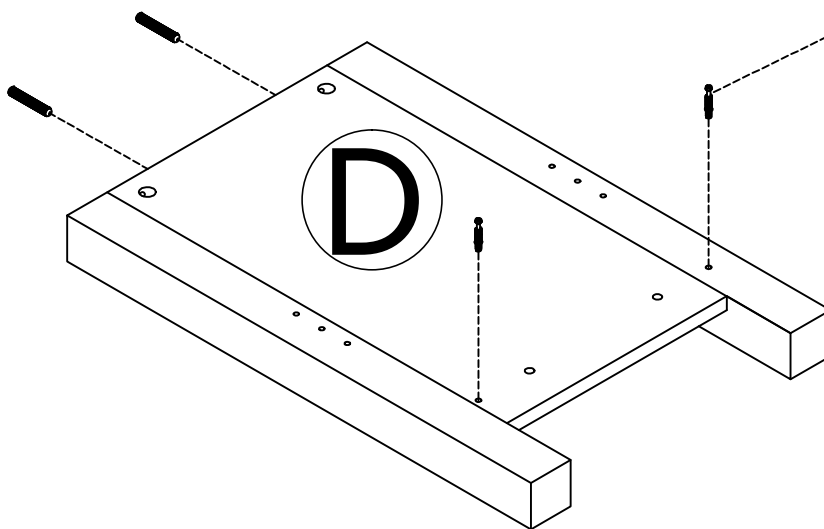
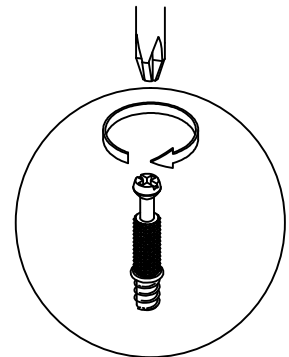
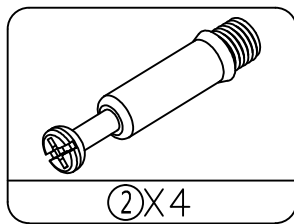
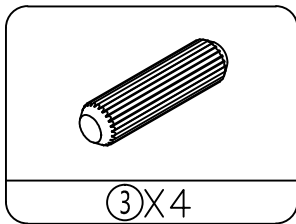

STEP 4

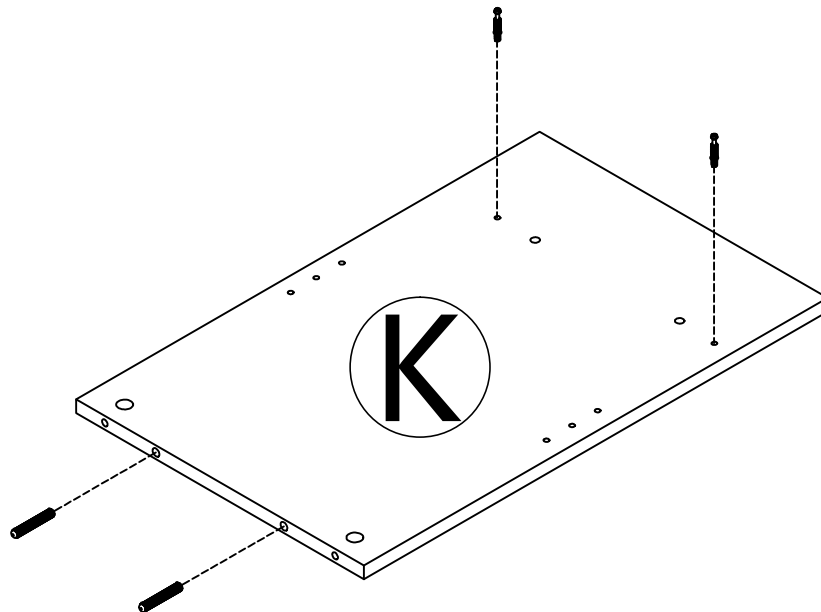
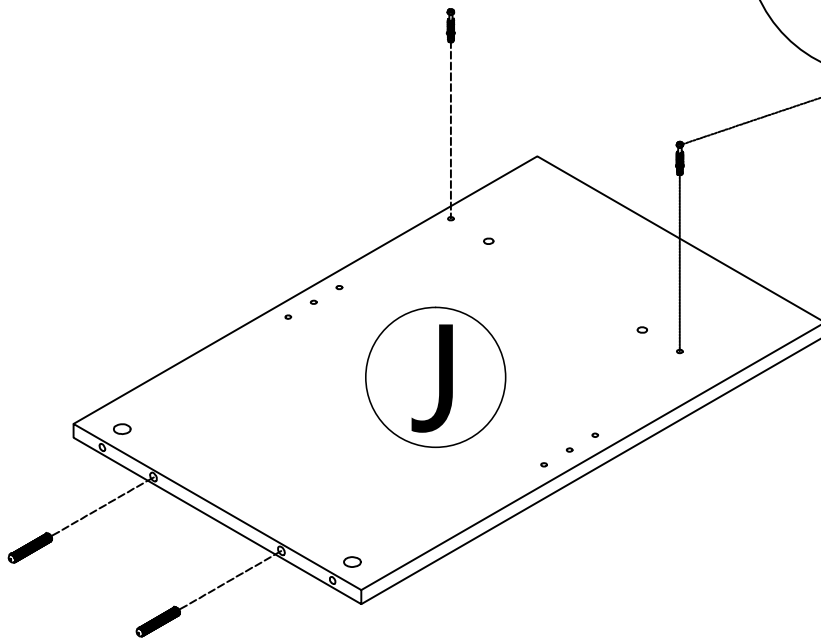
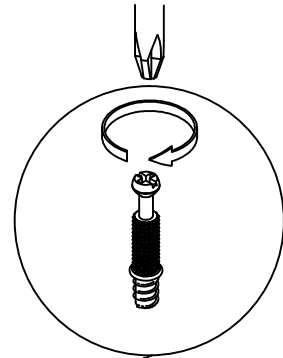
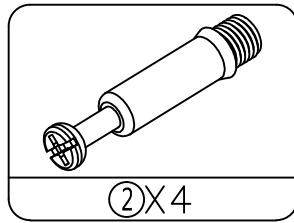
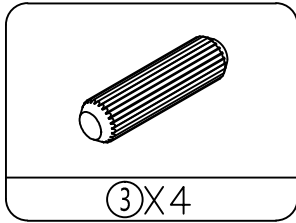

STEP 5

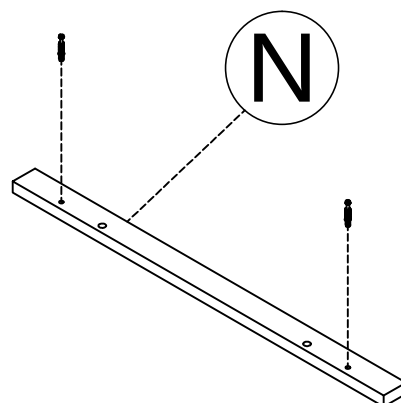
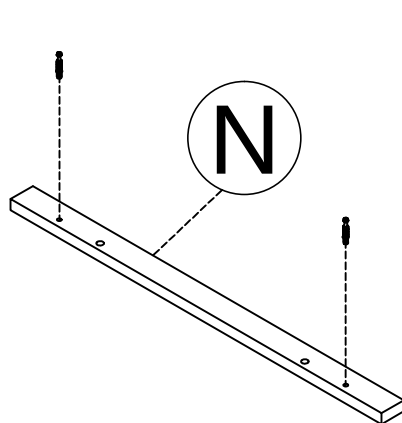
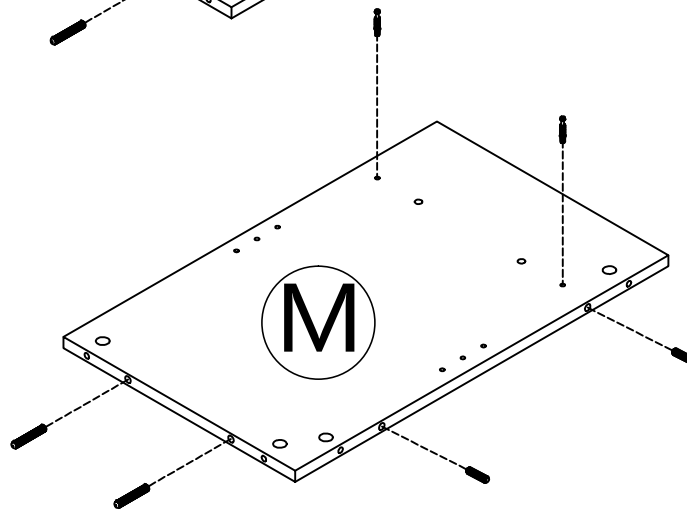
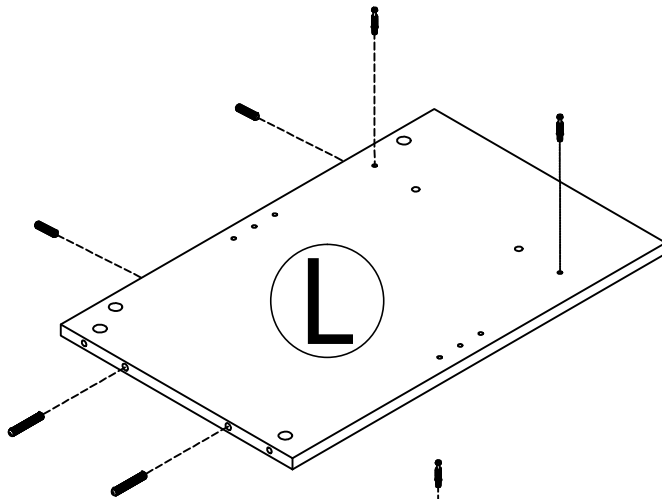
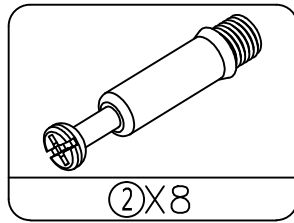
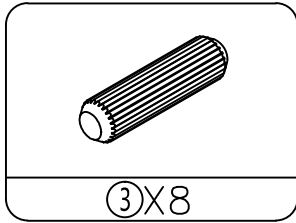

STEP 6

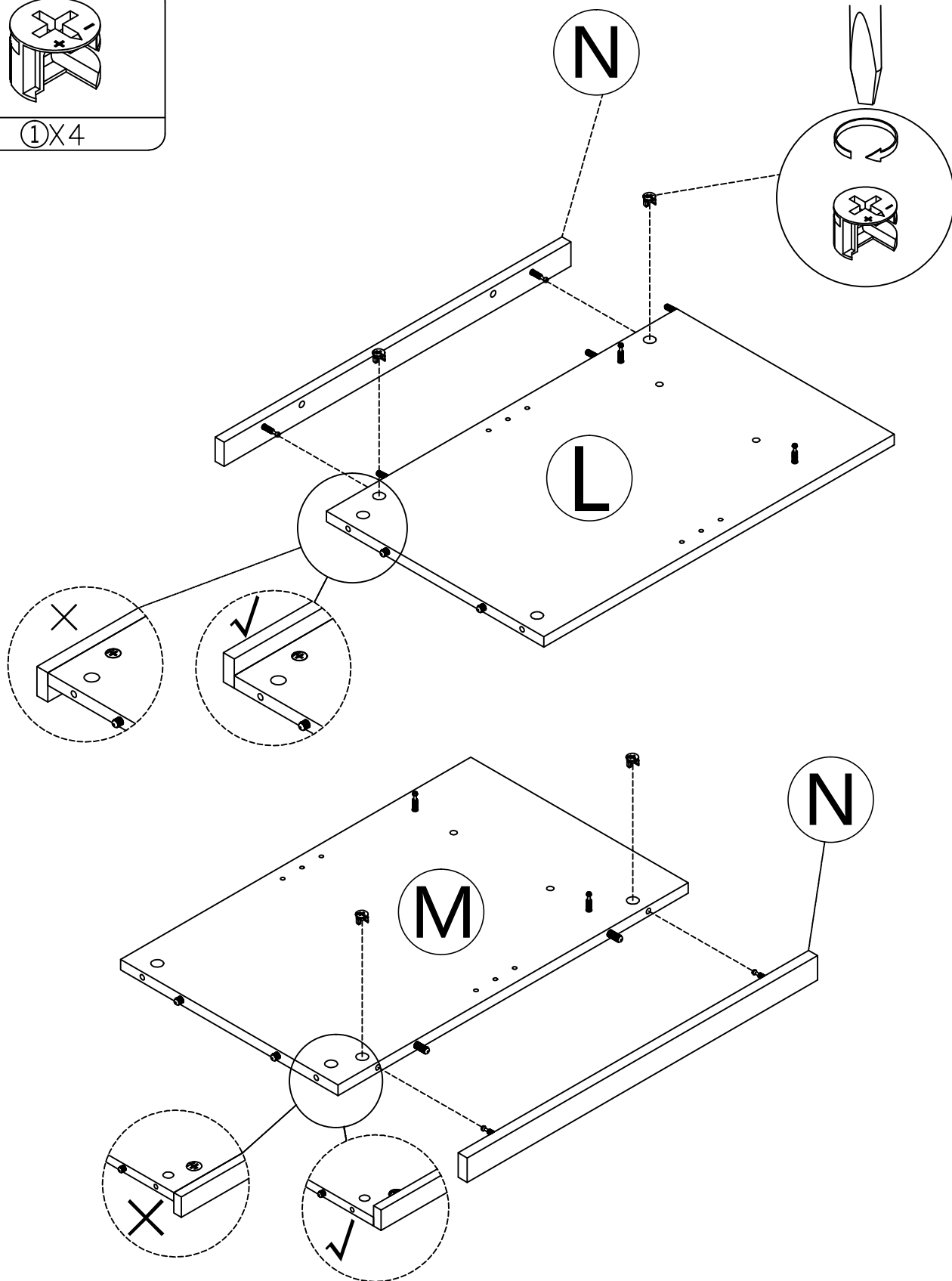
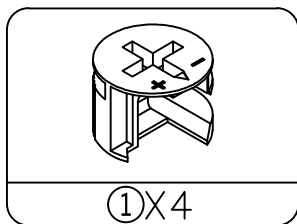

STEP 7

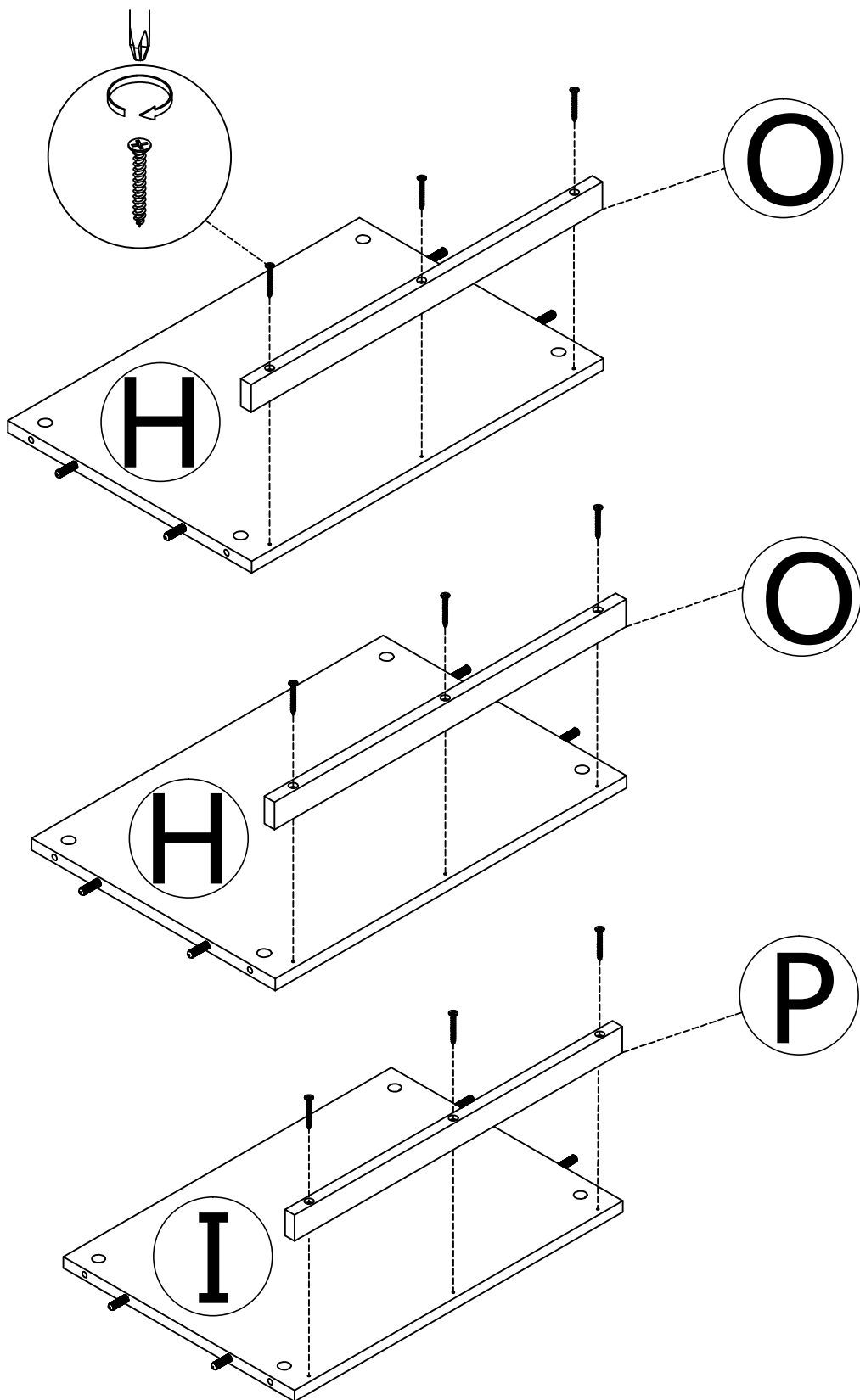
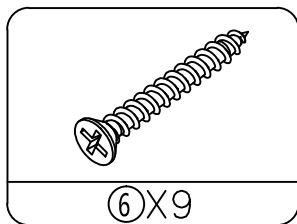

STEP 8

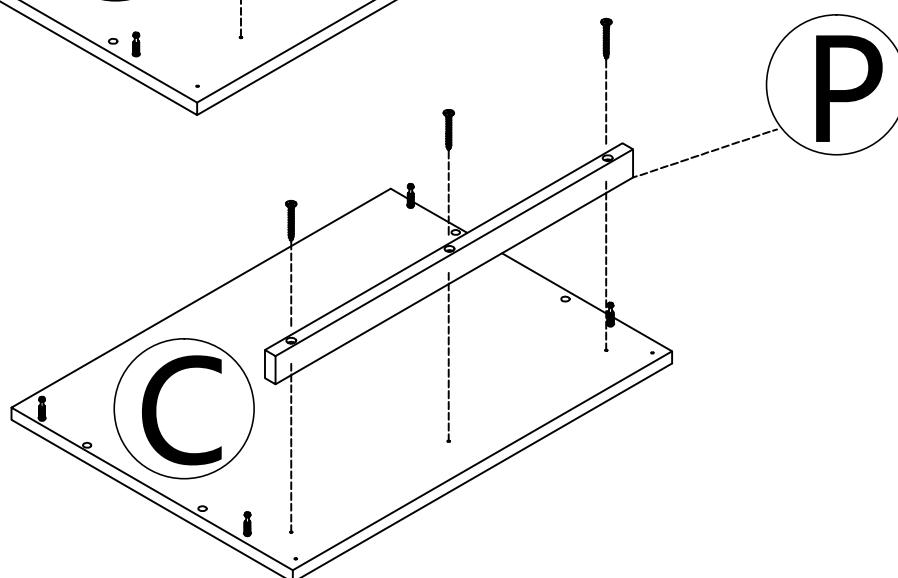
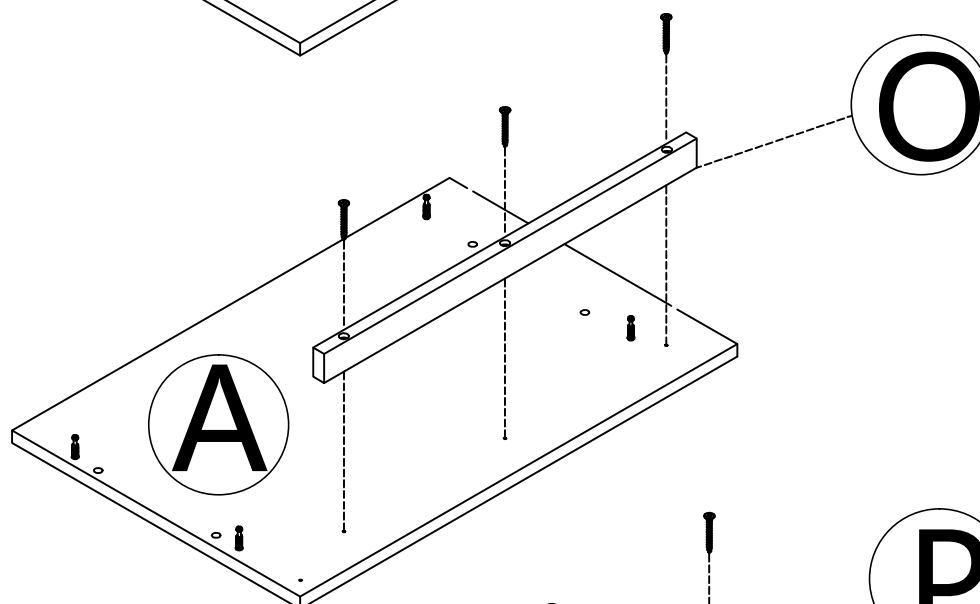
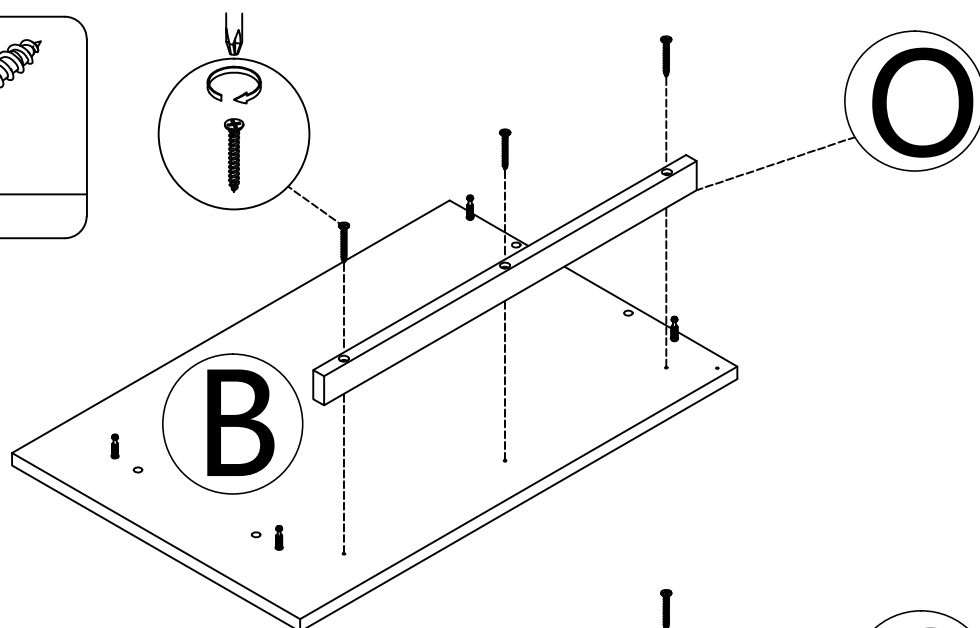
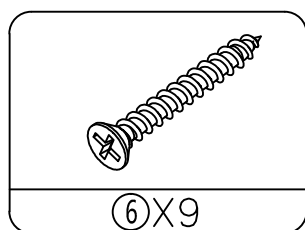

STEP 9

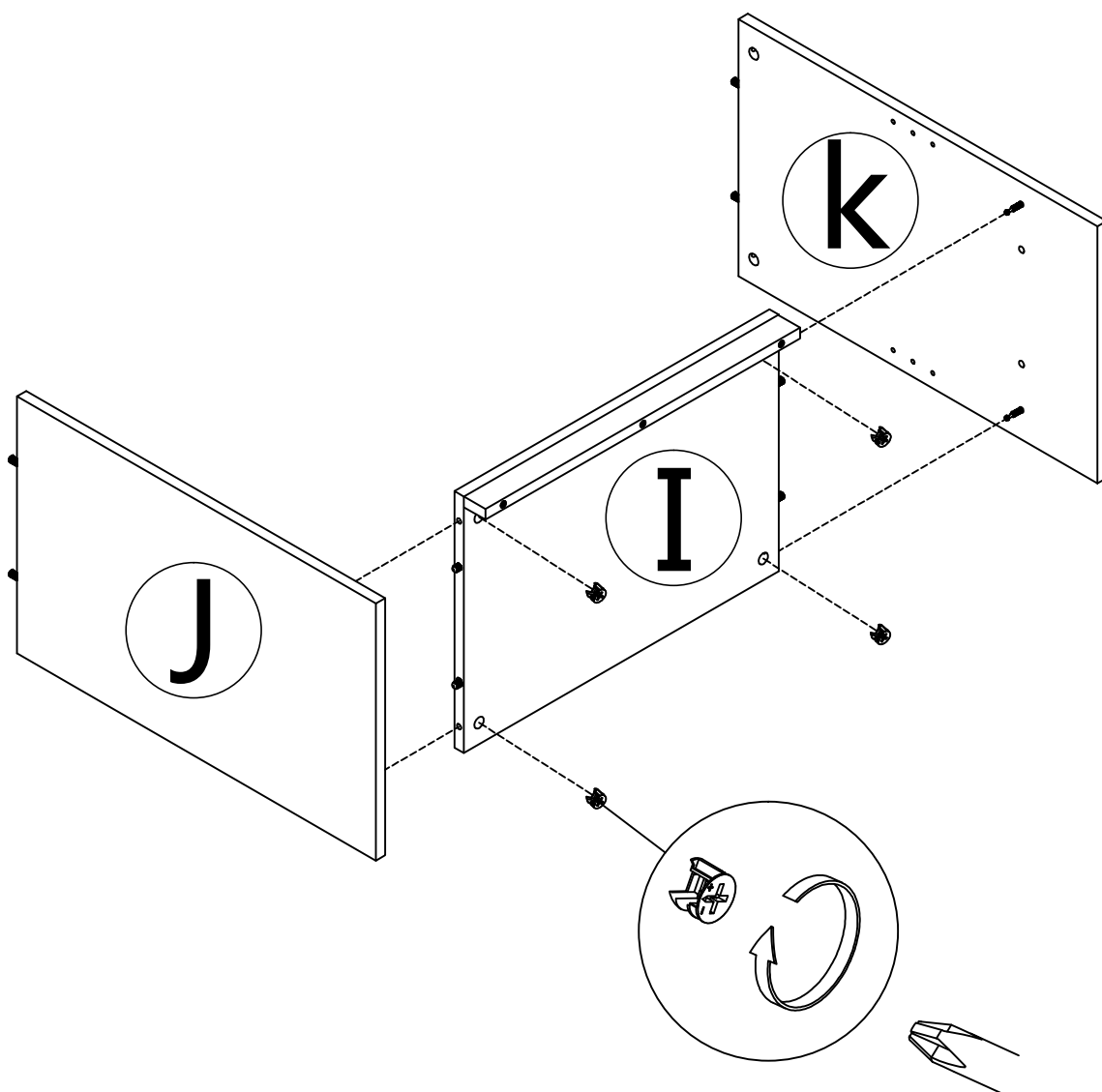
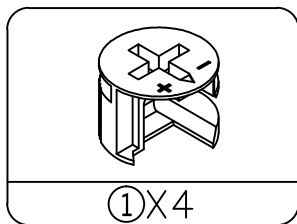

STEP 10

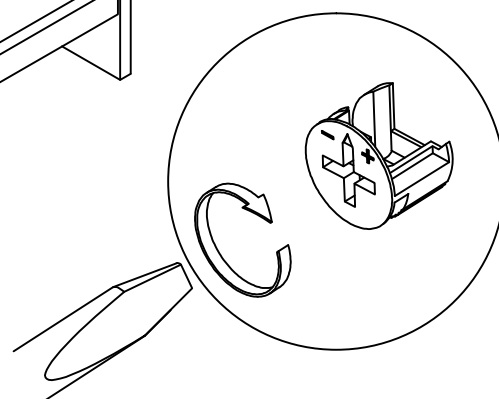
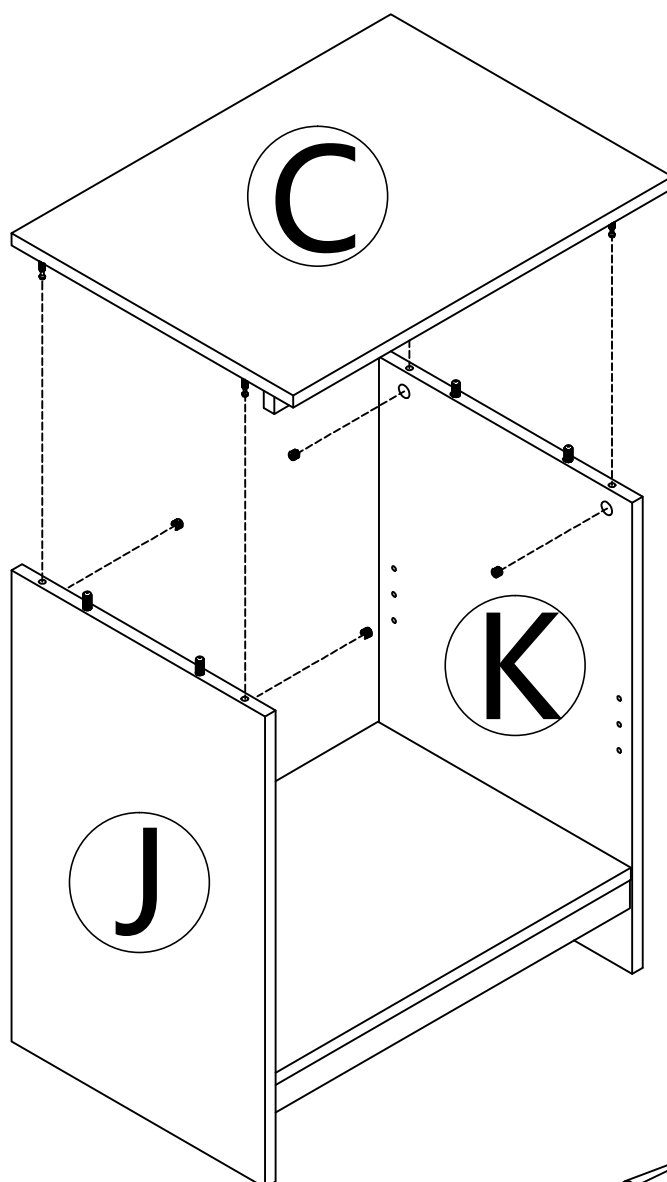
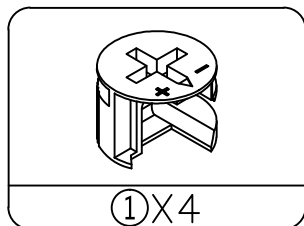

STEP 11

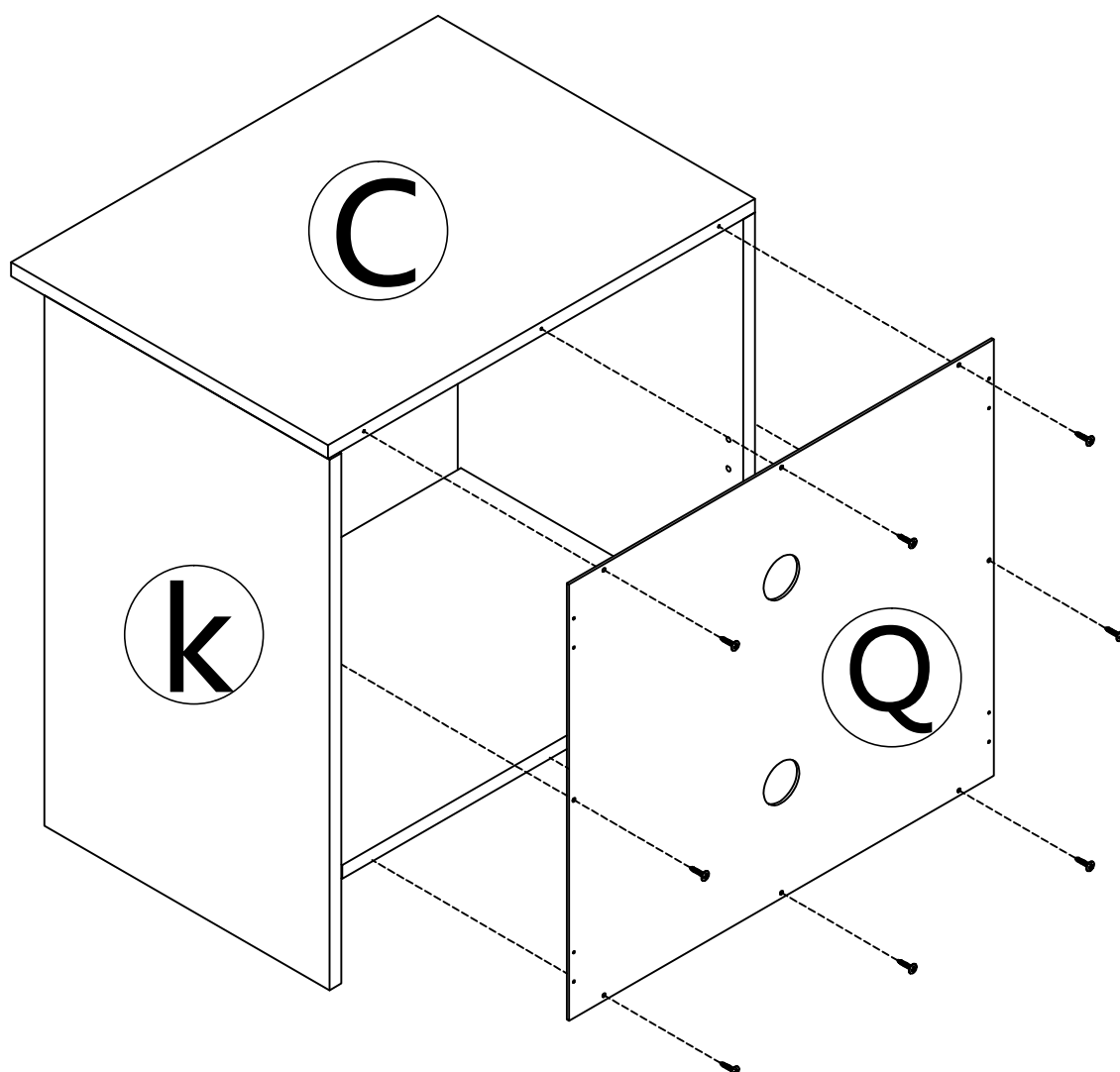
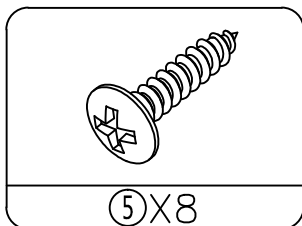

STEP 12

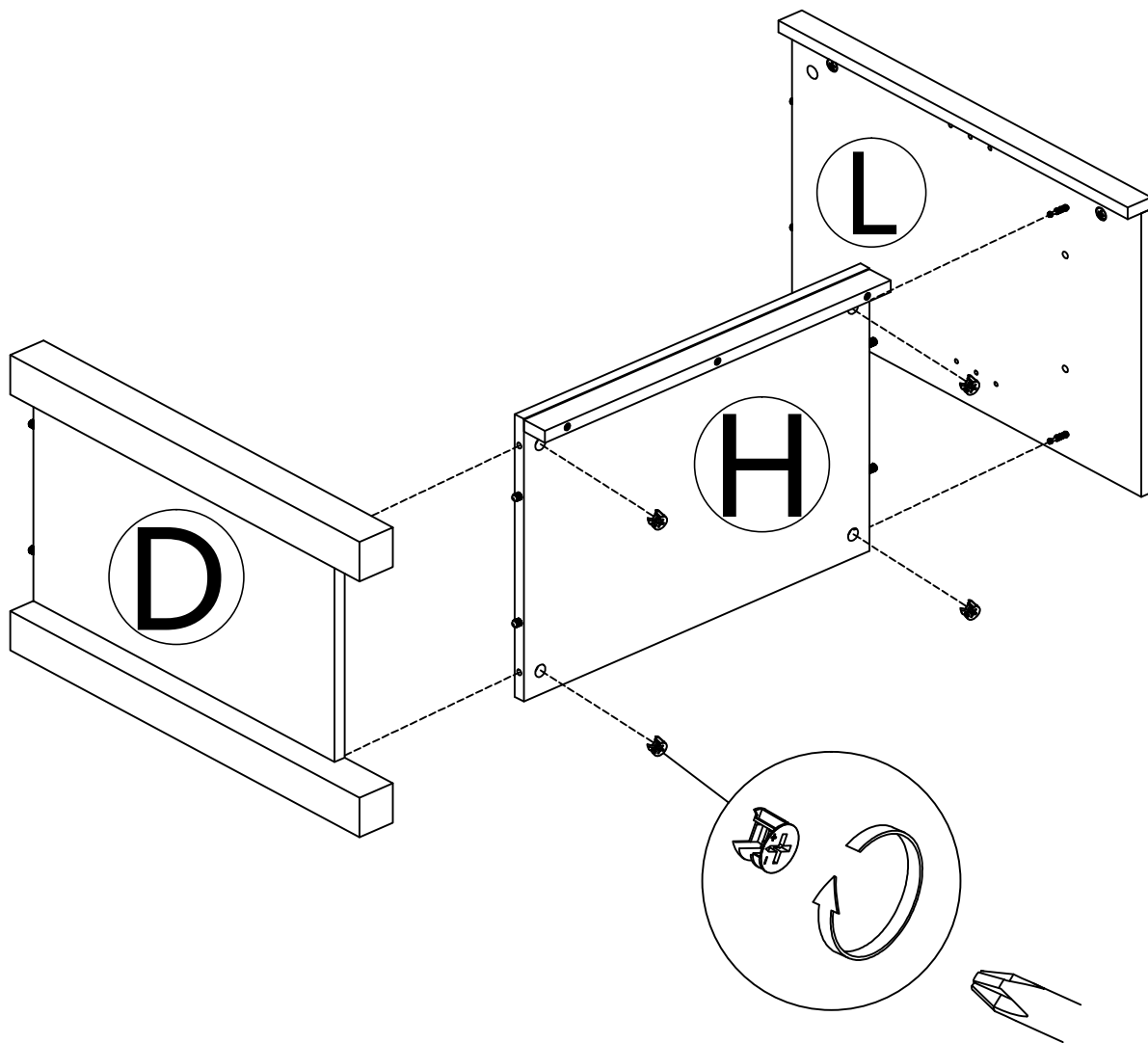
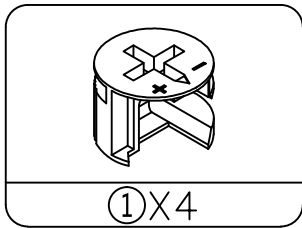

STEP 13

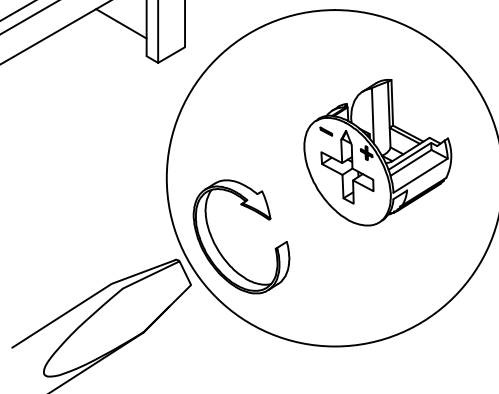
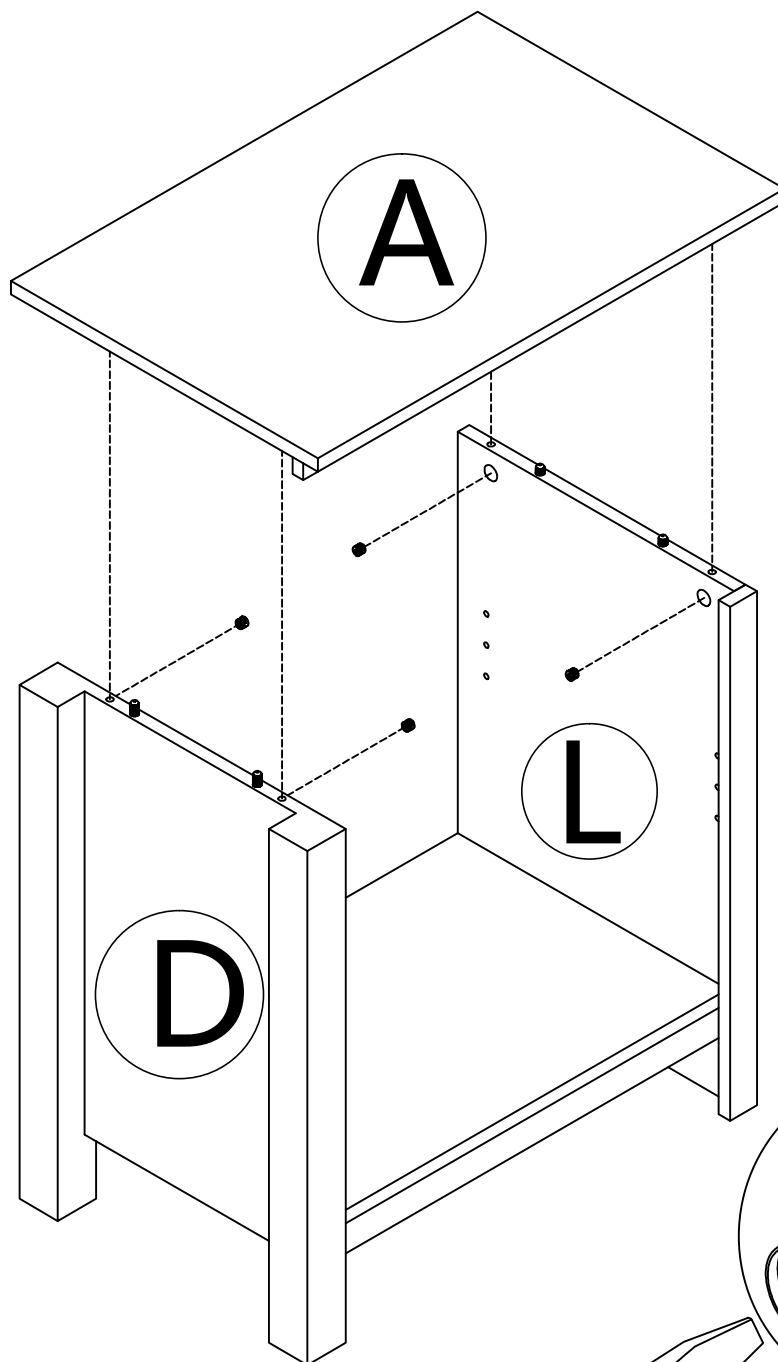
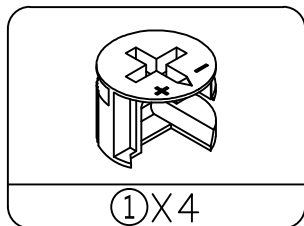

STEP 14

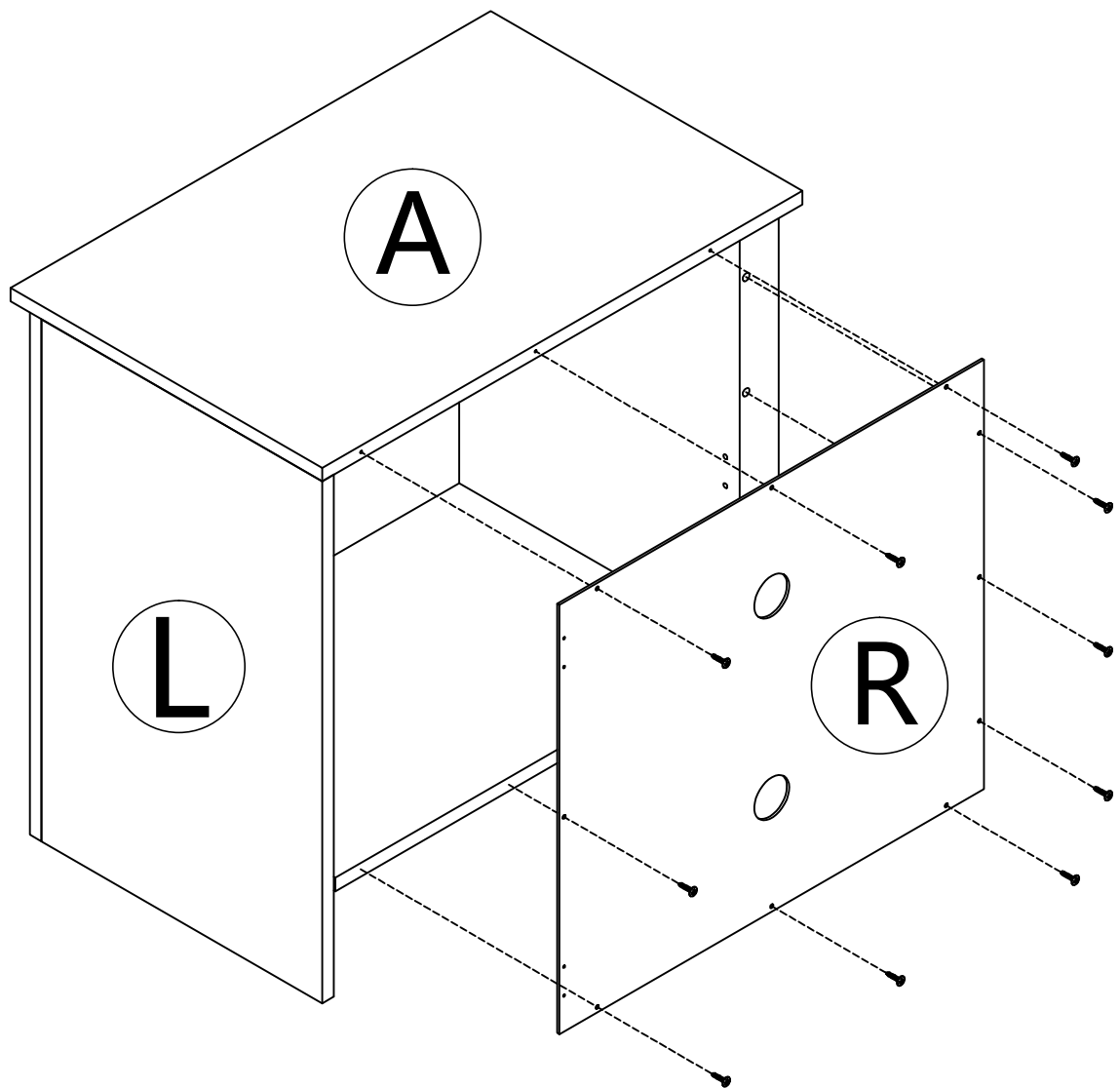
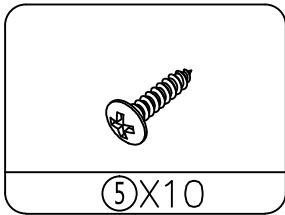

STEP 15

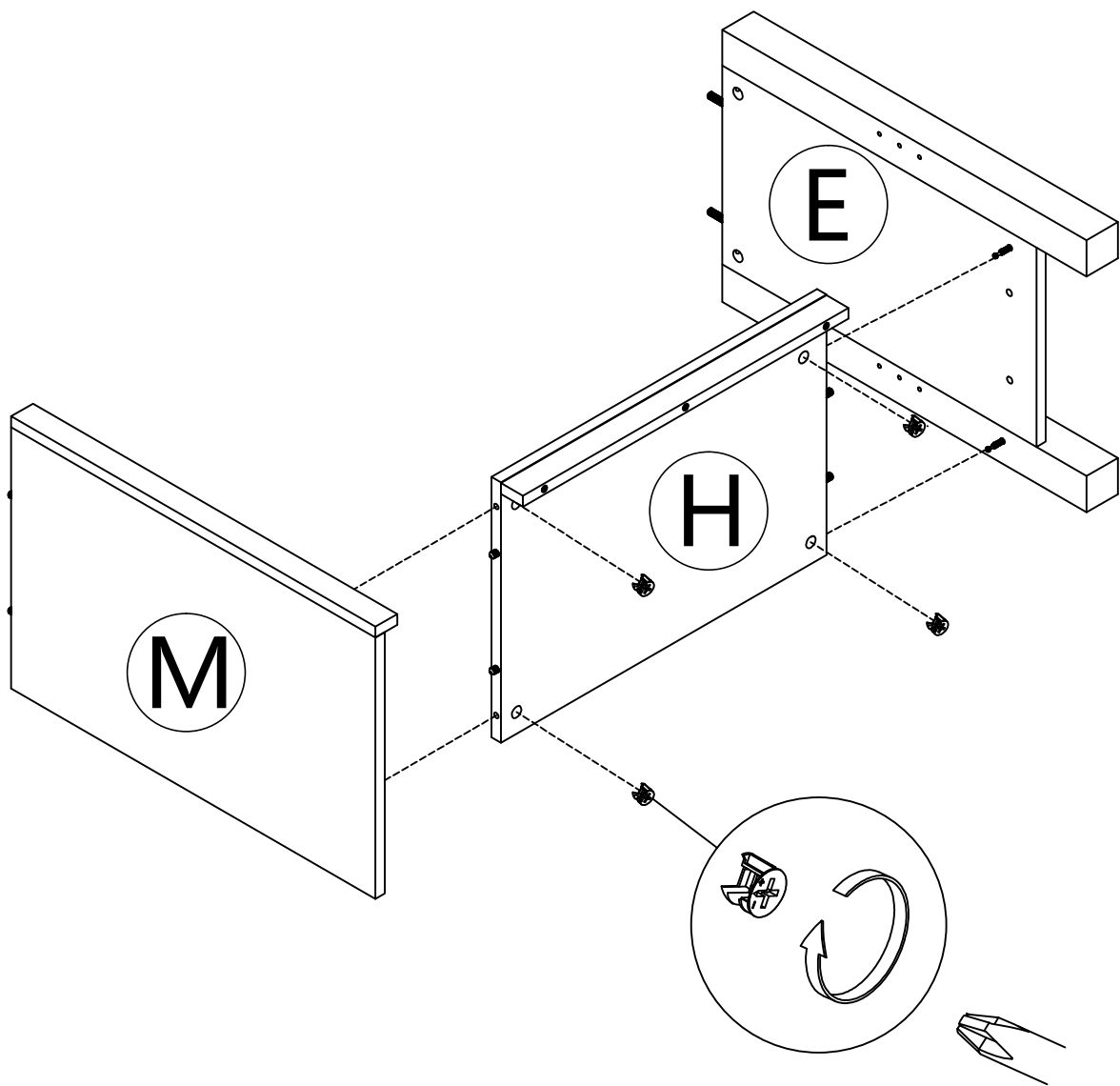
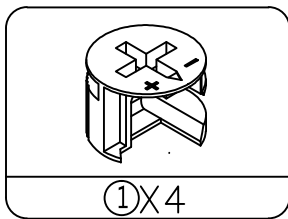

STEP 16

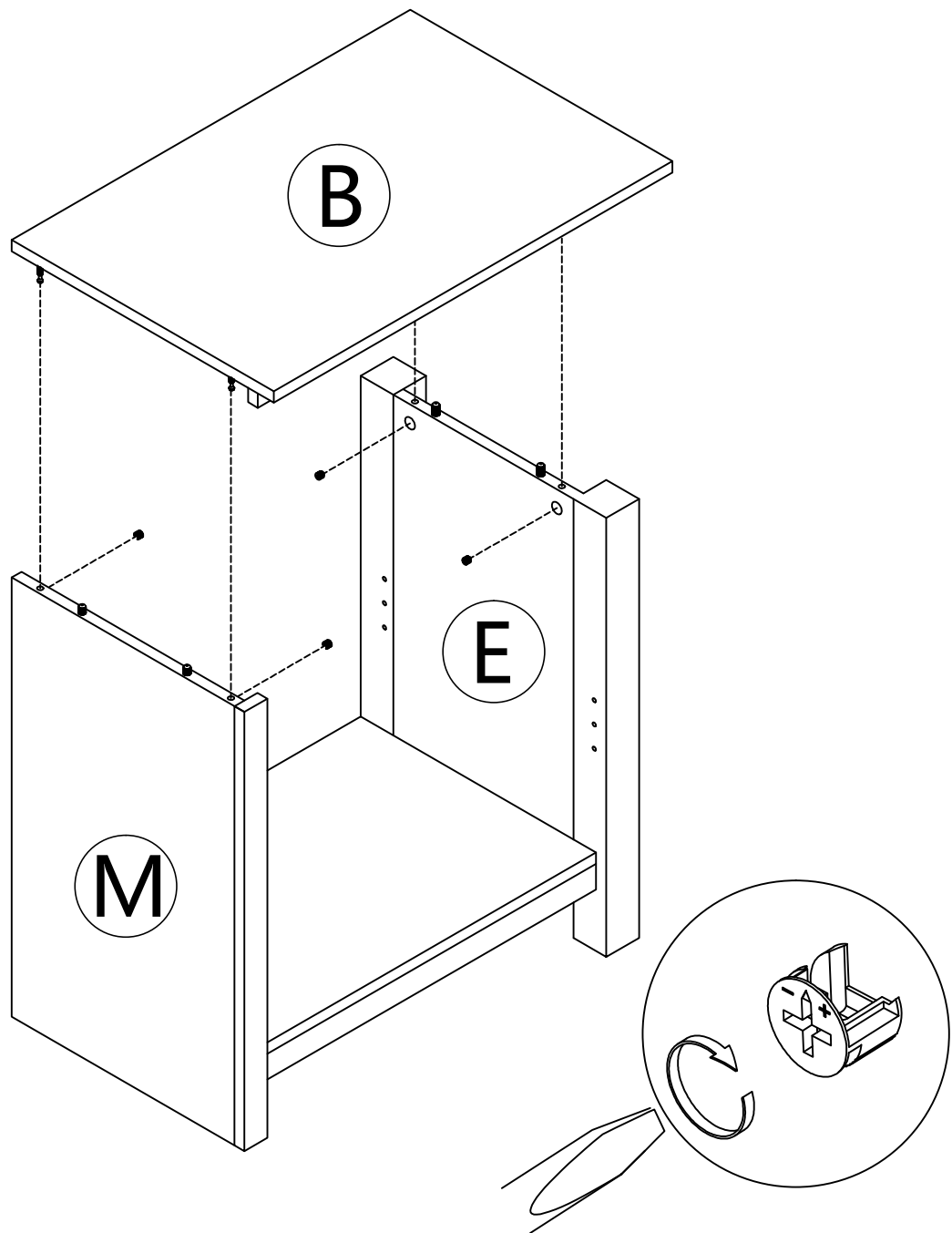
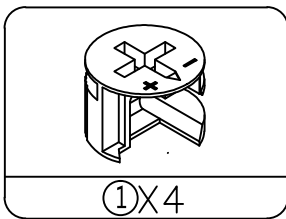

STEP 17

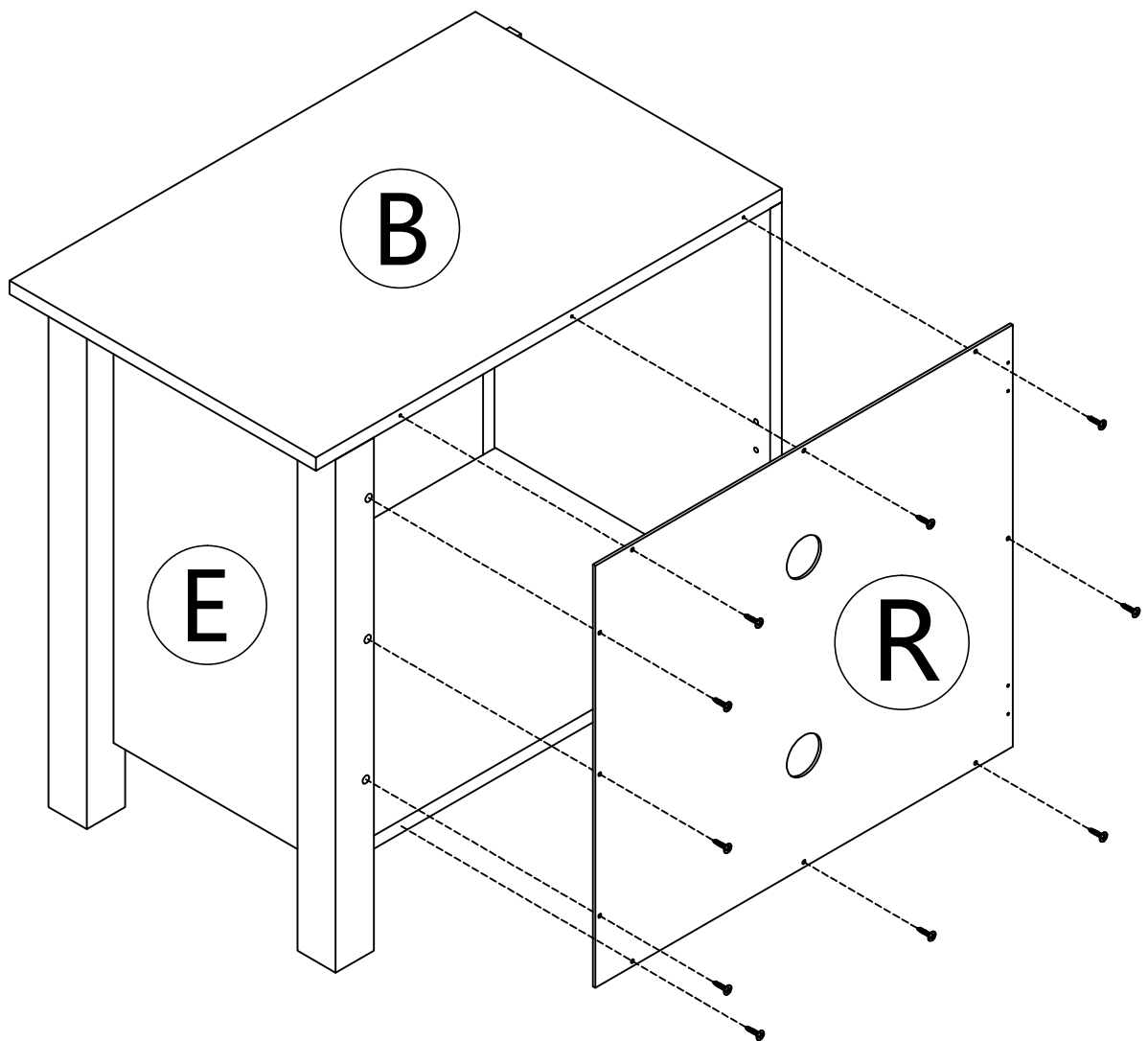
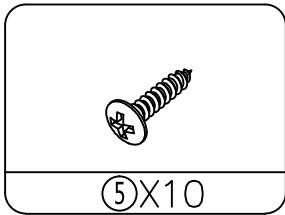

STEP 18

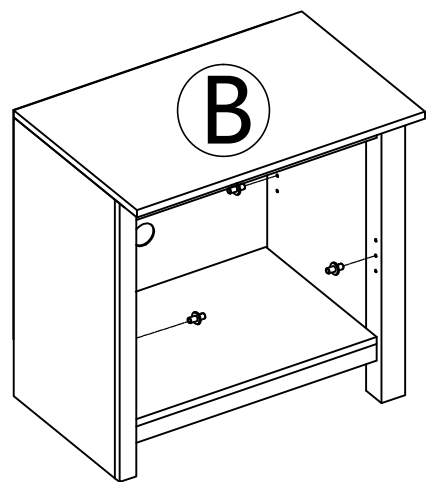
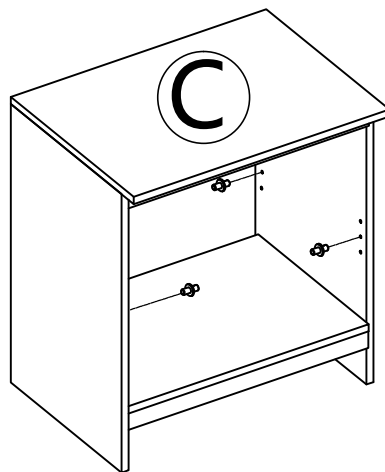
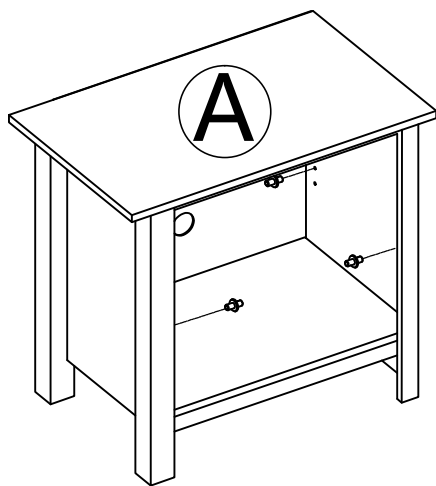
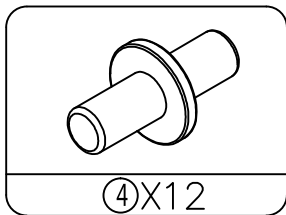

STEP 19

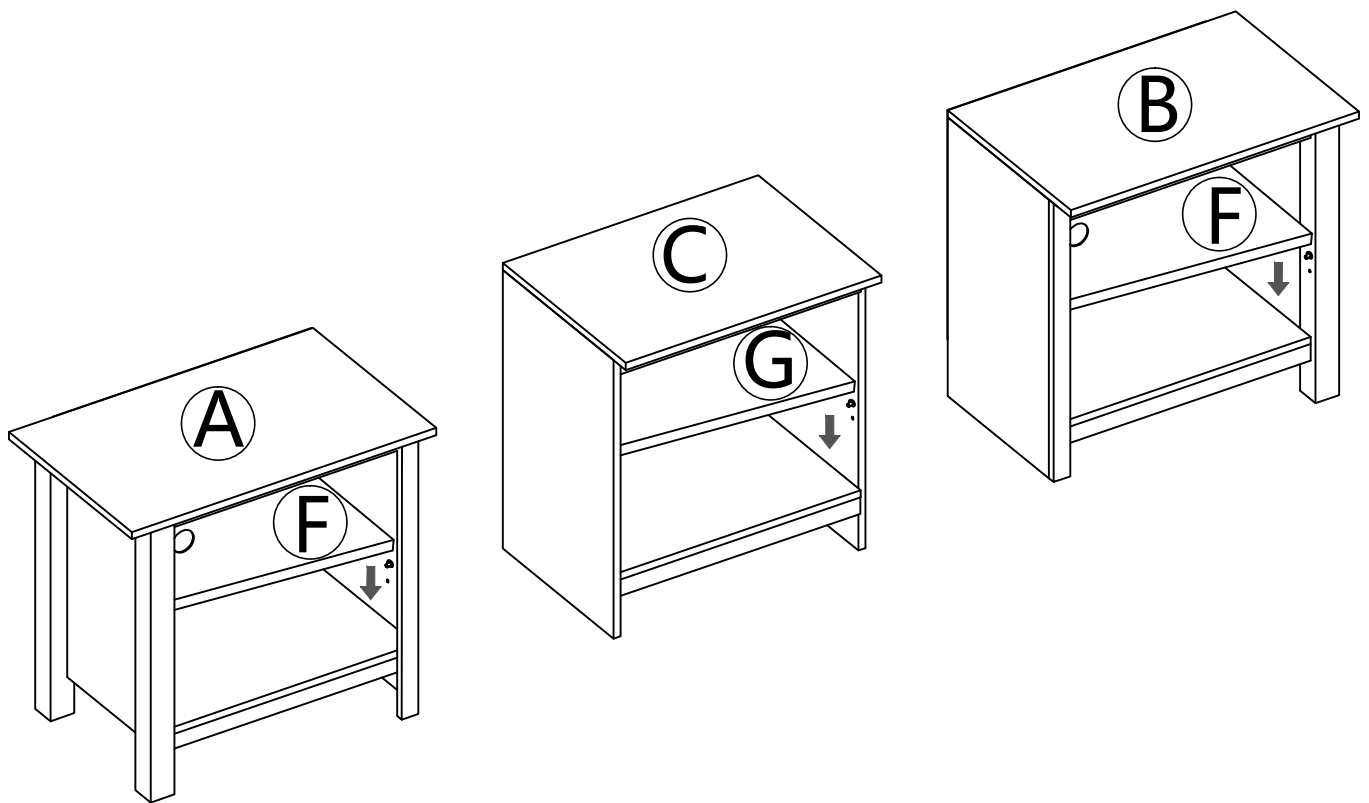

STEP 20

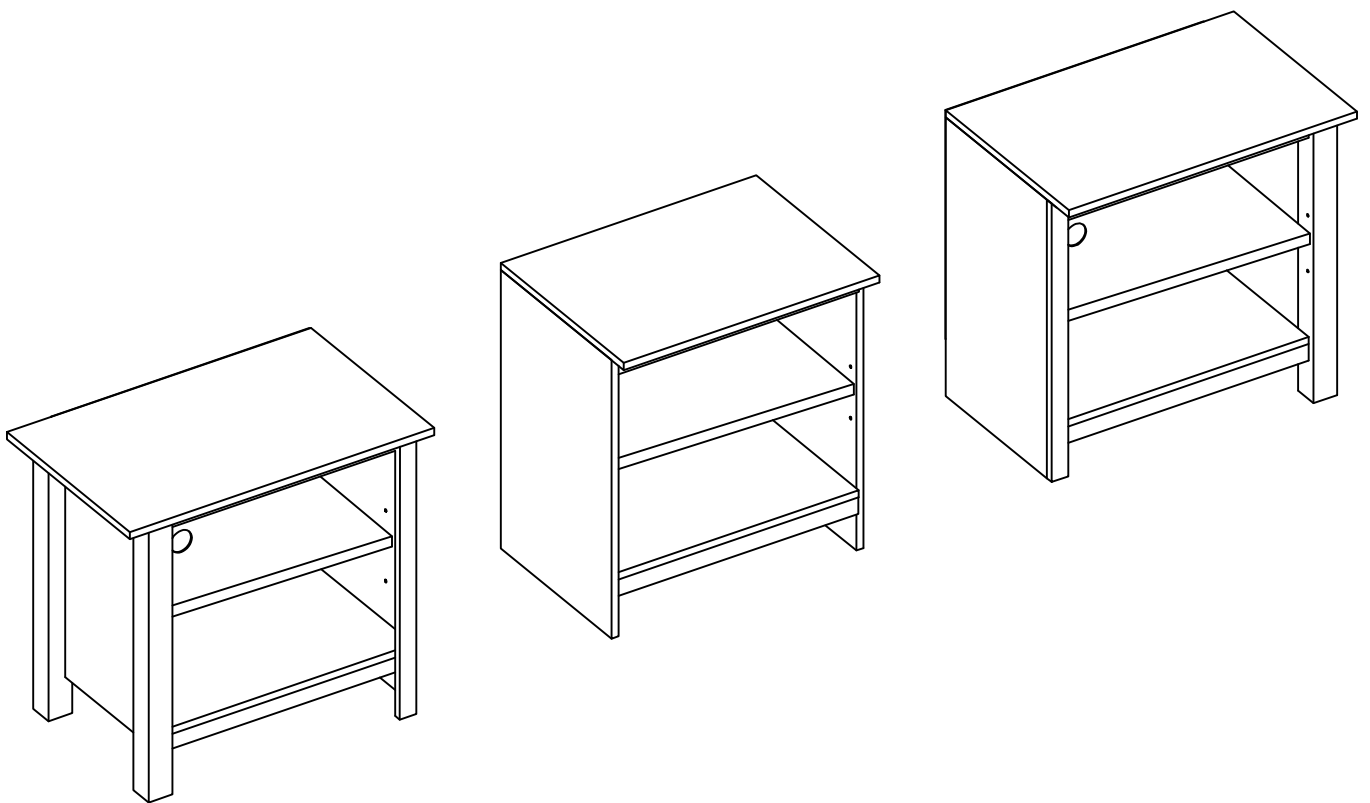

STEP 21

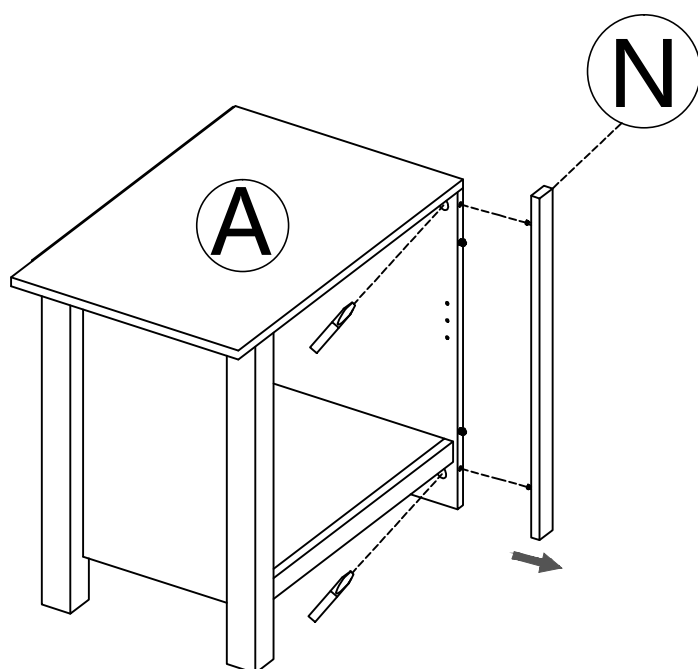

Remove the panel N
and turn up and down

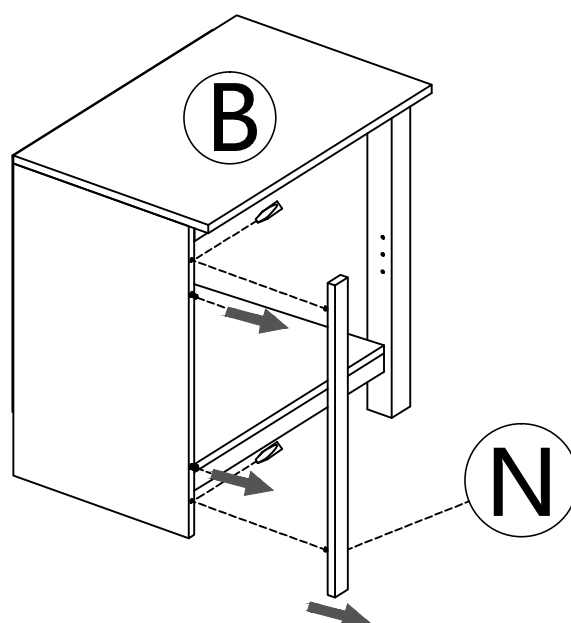
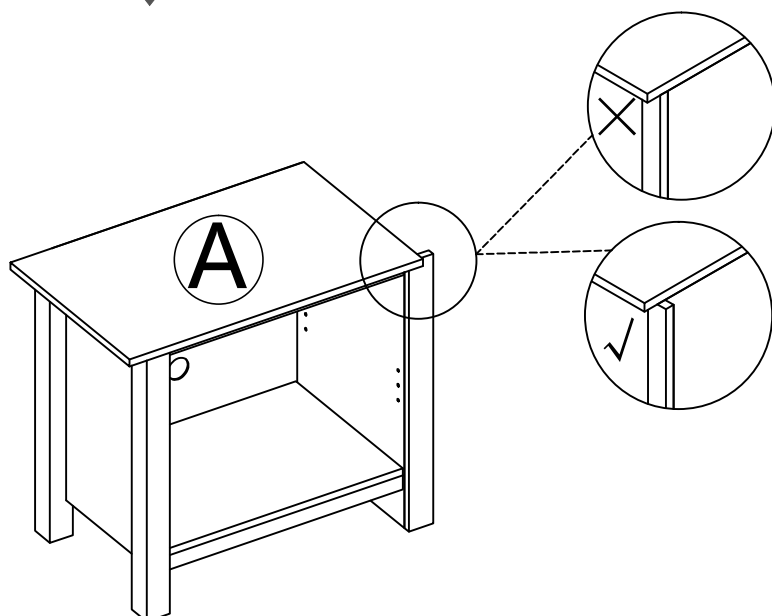

Remove the panel N
and wood dowel
and do not use

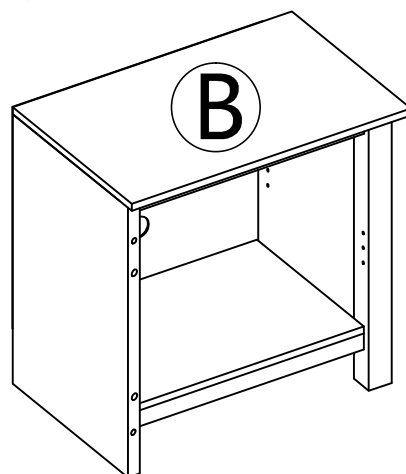

STEP 22

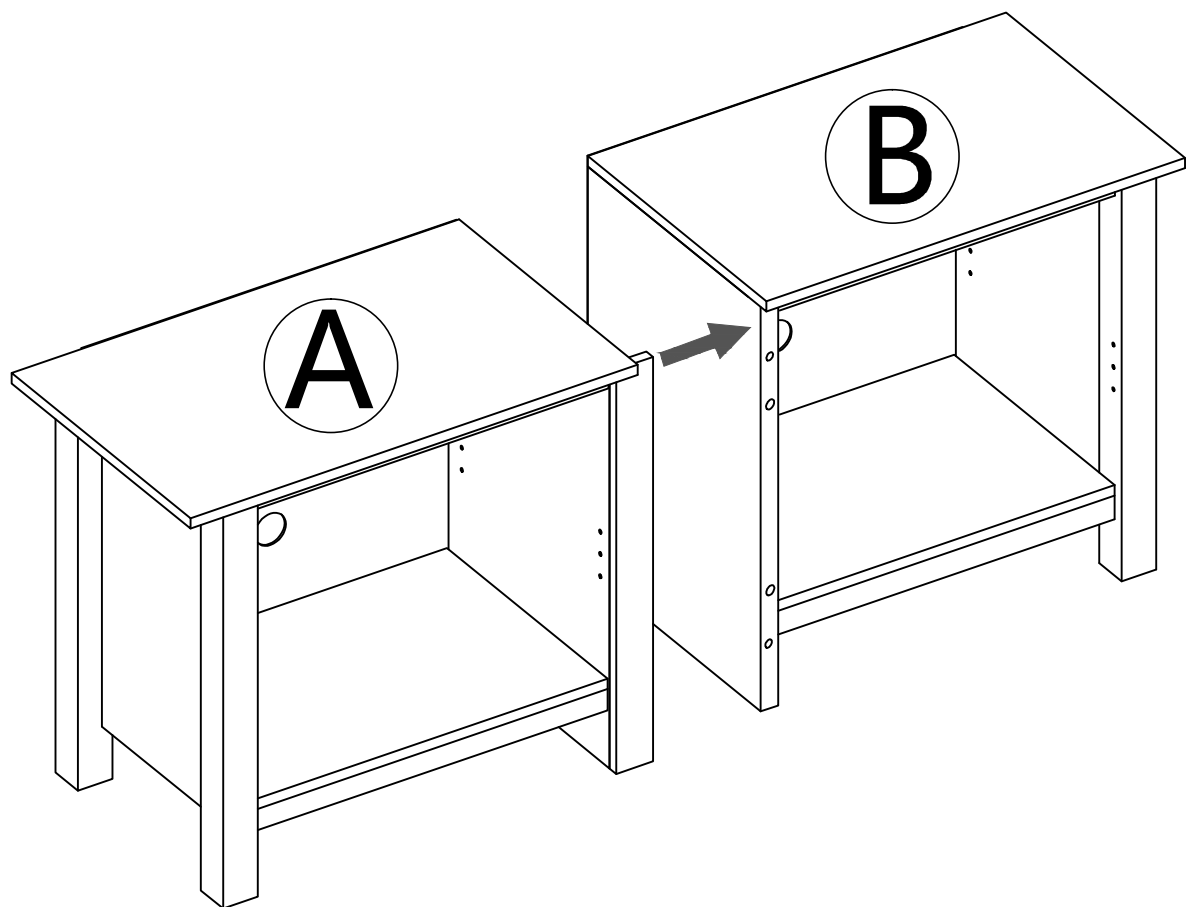

STEP 23

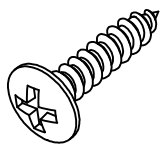

⑤X10

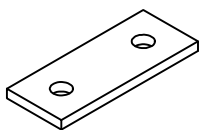

⑦X1

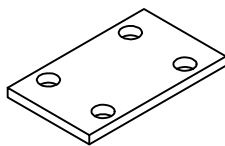

⑧X2

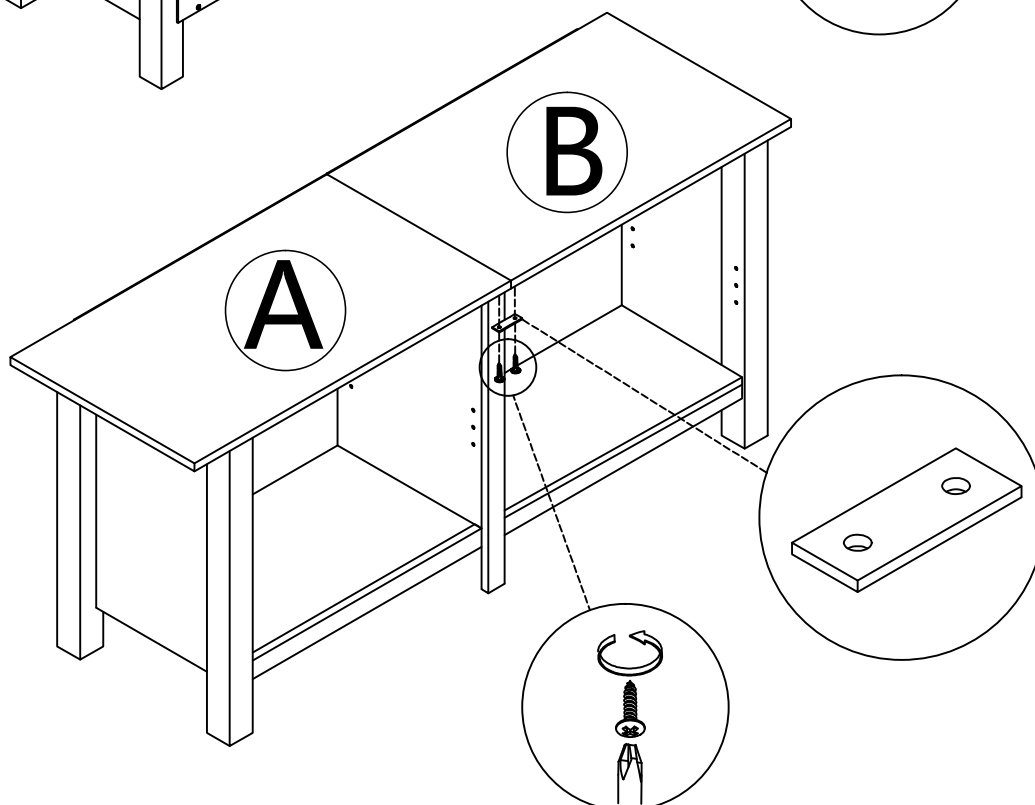
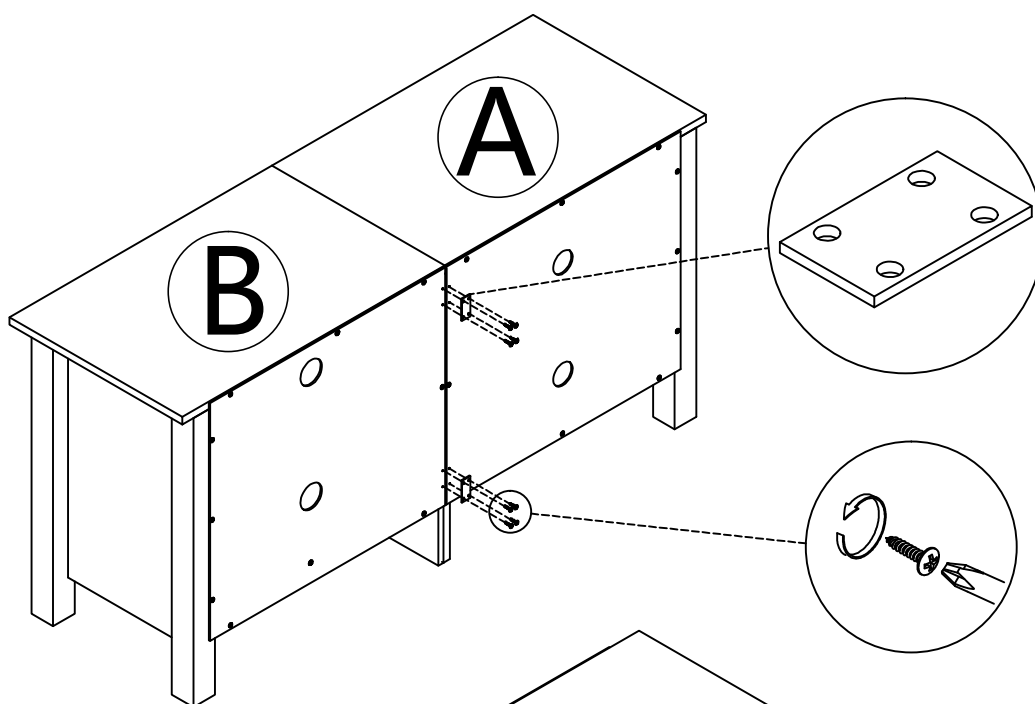

STEP 24

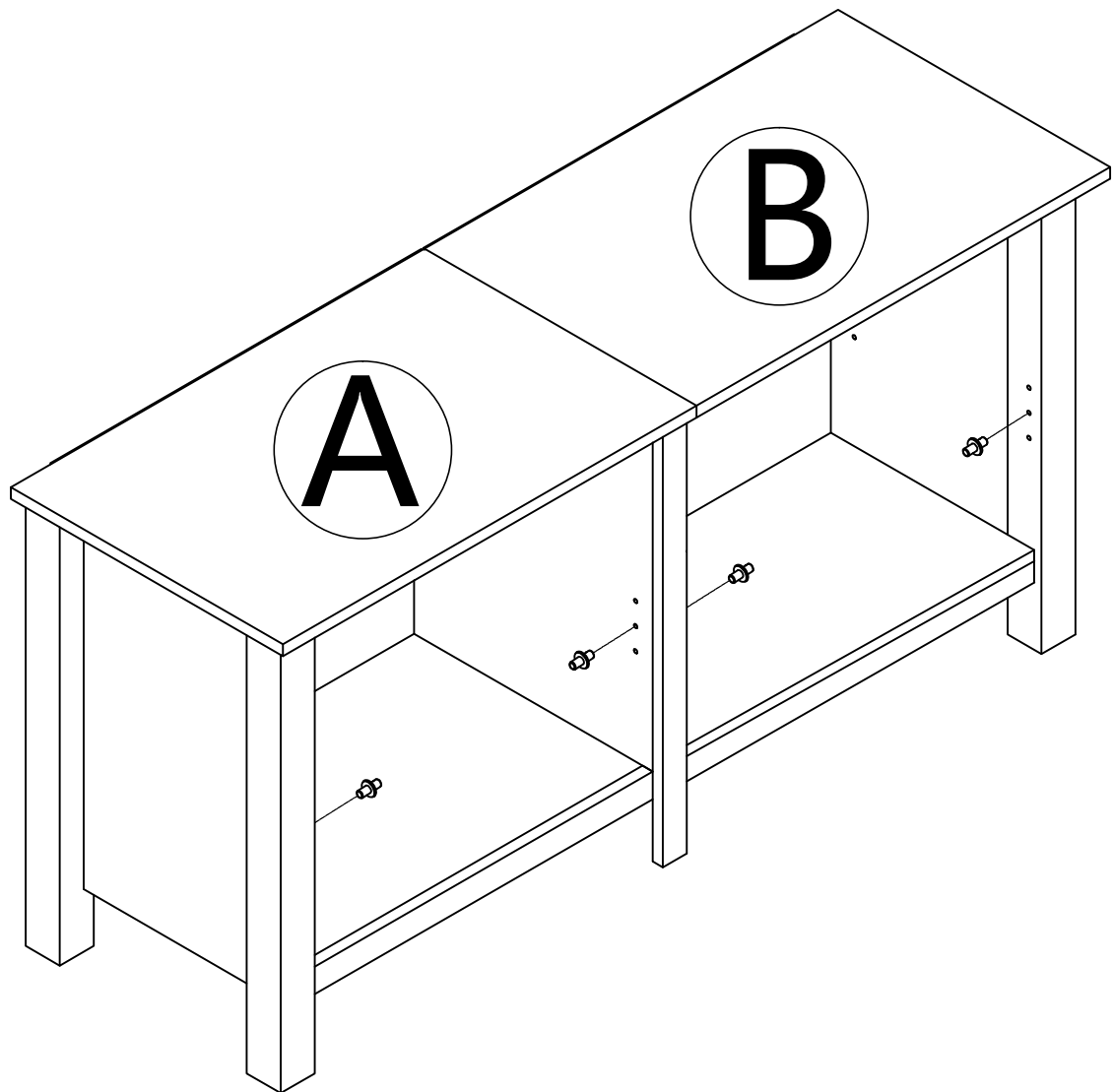
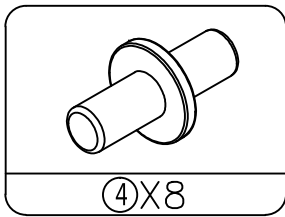

STEP 25

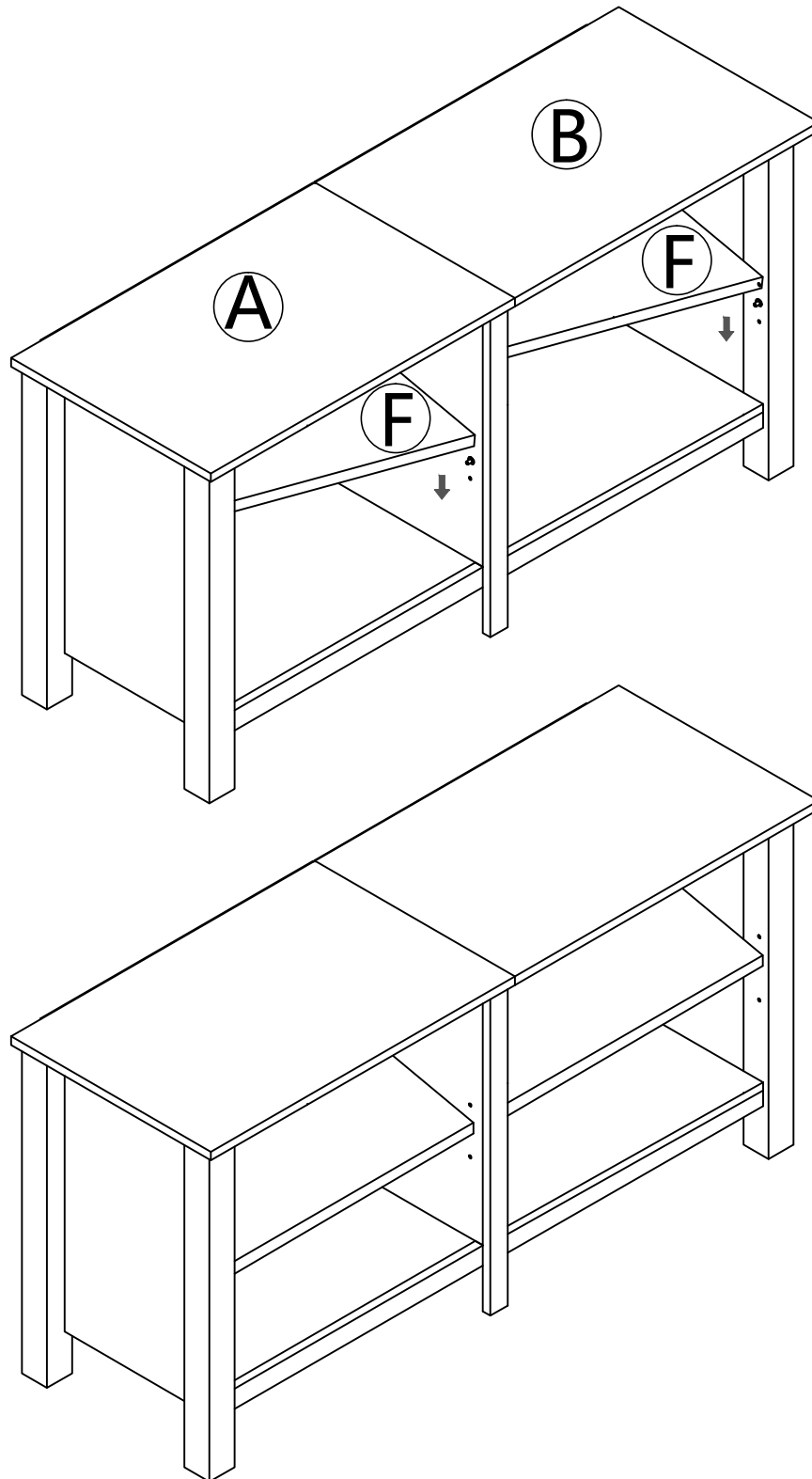

STEP 26

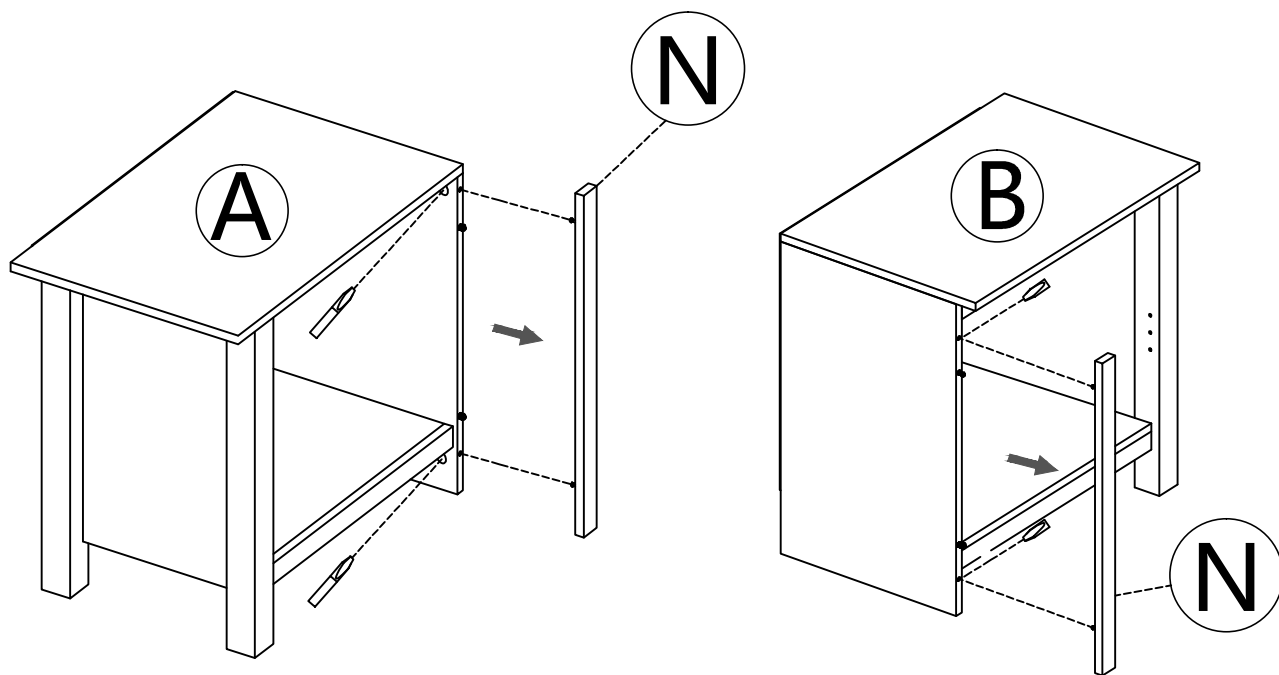

Remove the panel N
and turn up and down

Remove the panel N
and turn up and down

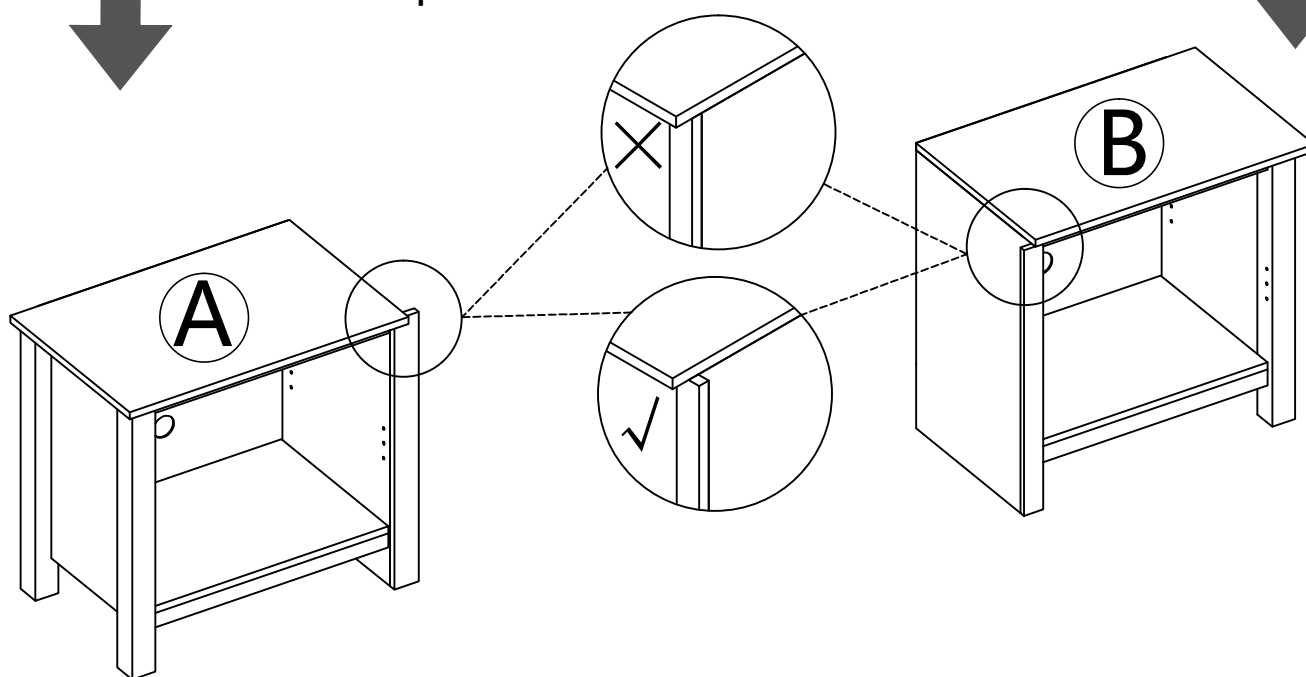

STEP 27

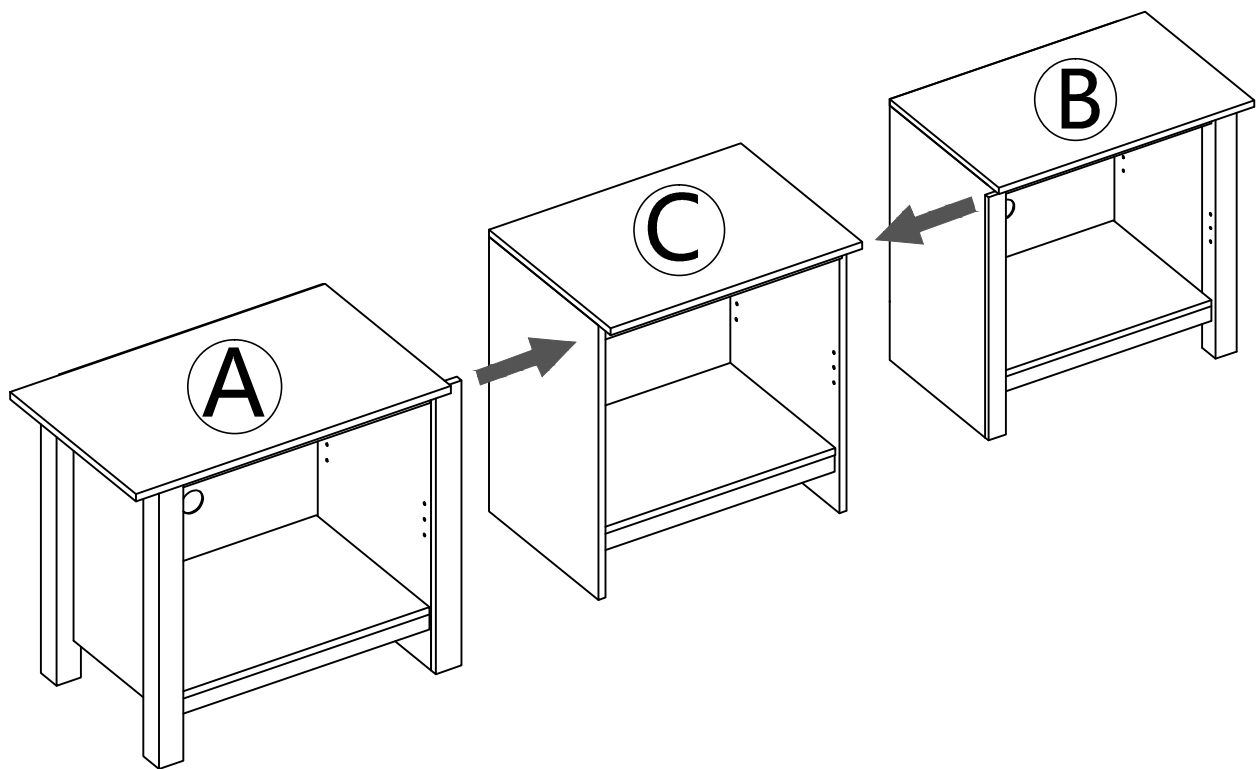

STEP 28

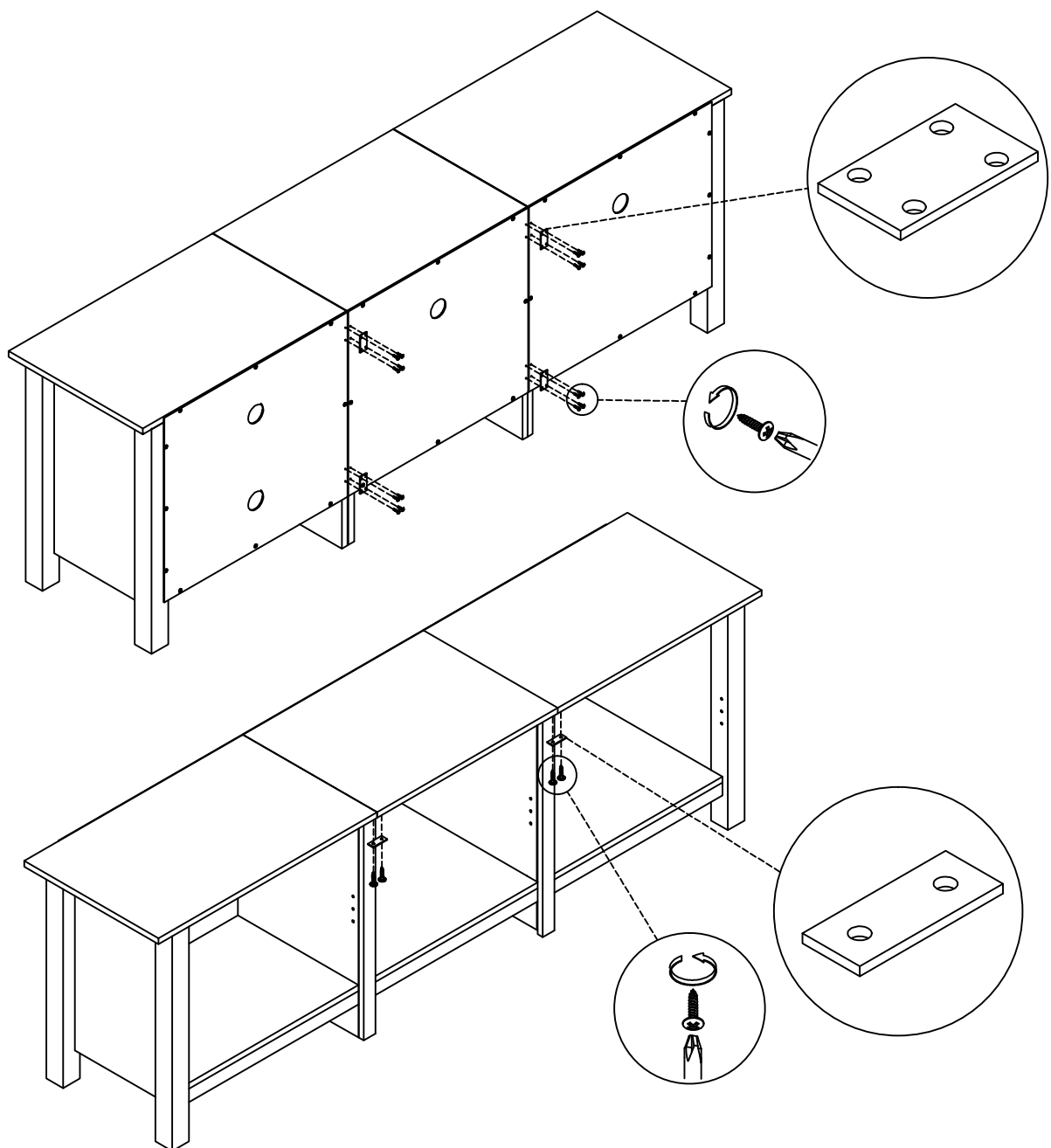
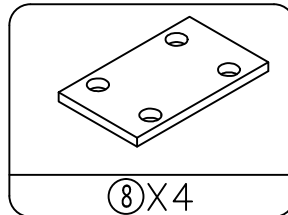
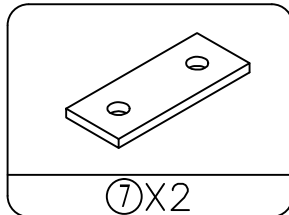
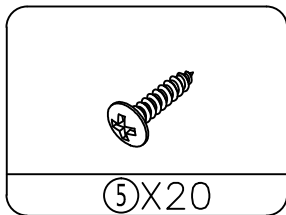

STEP 29

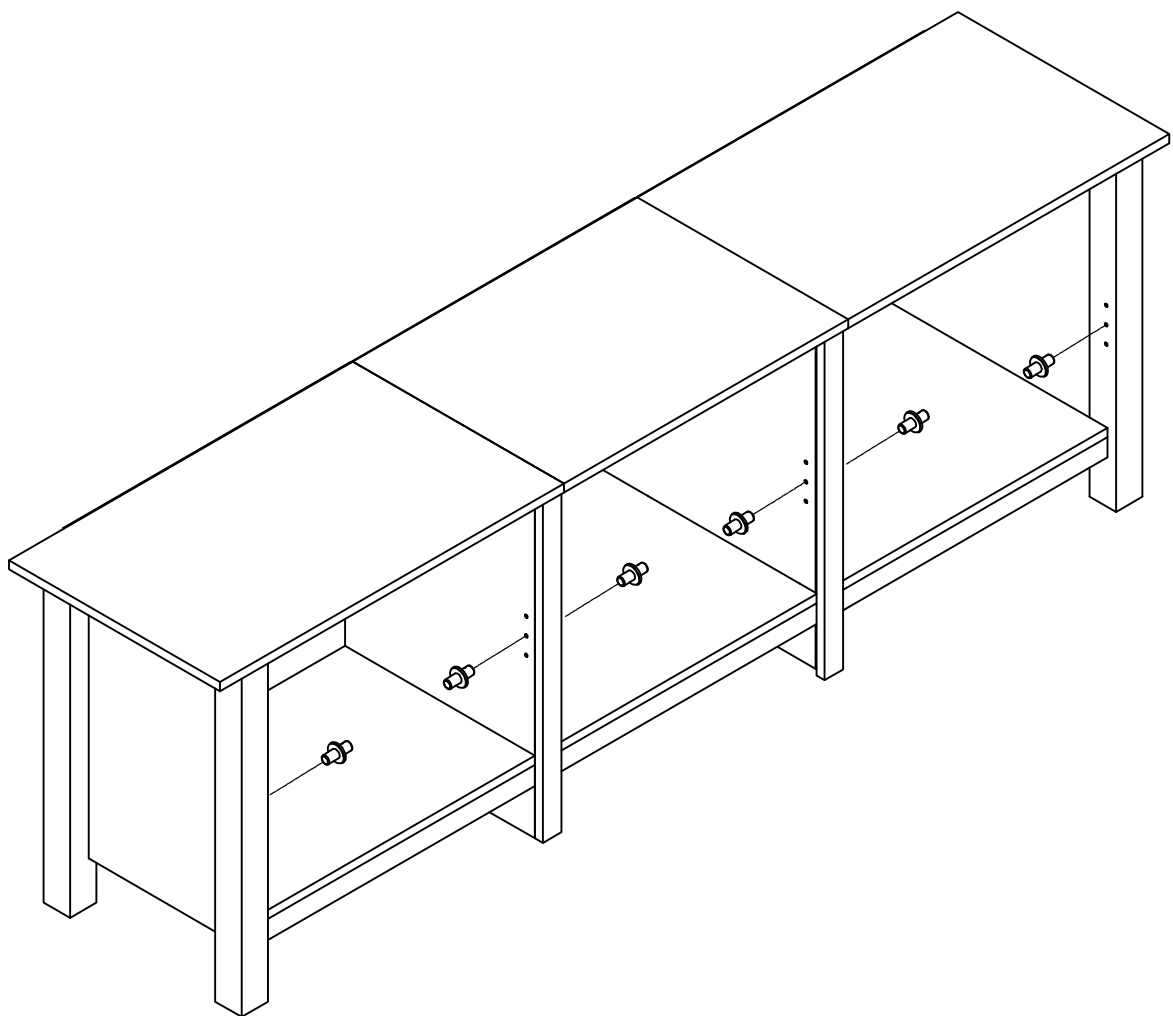
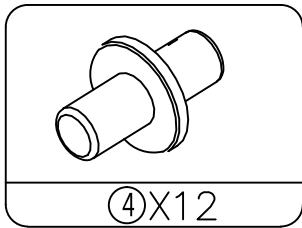

STEP 30

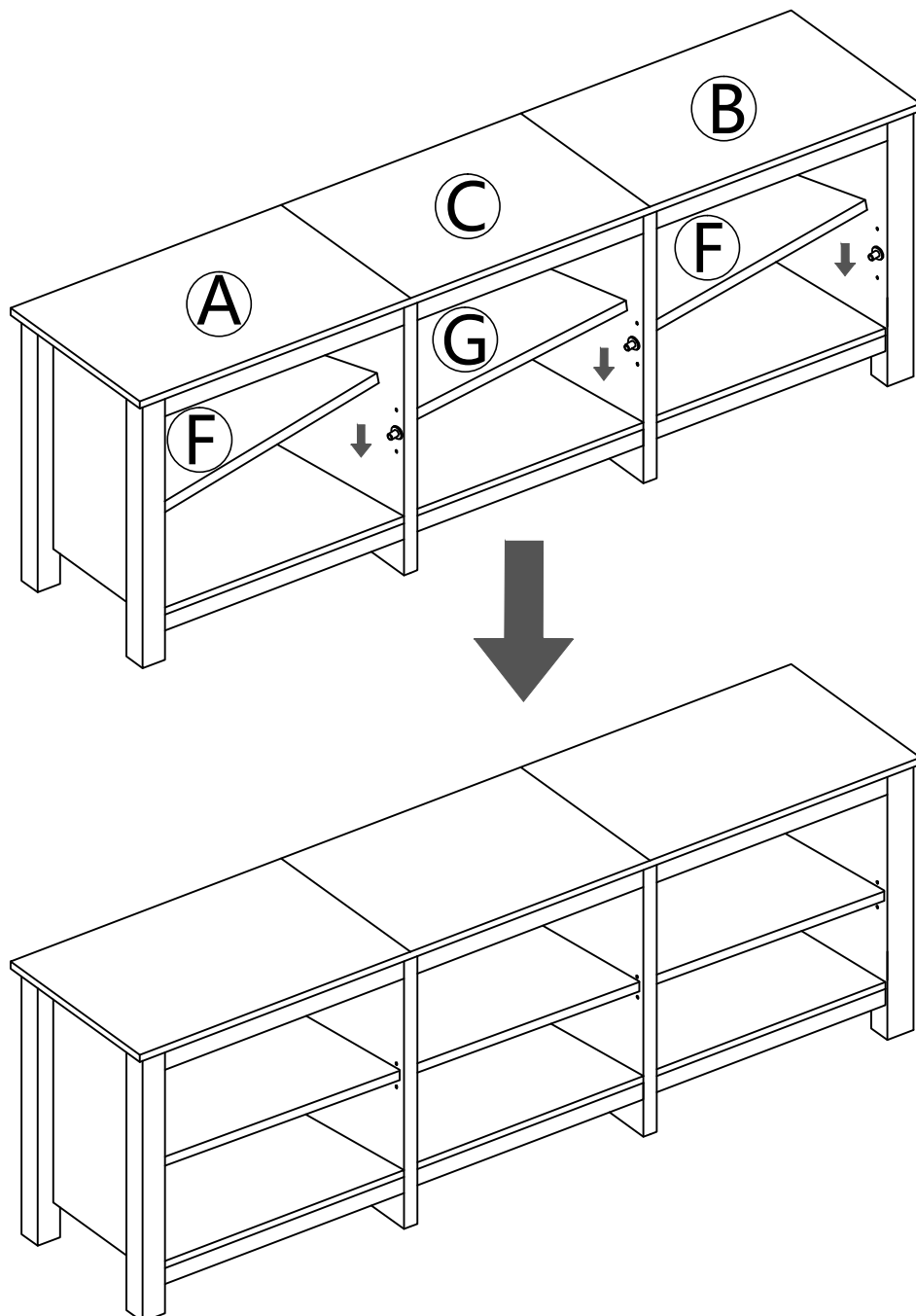

Maximum Load

This unit has been designed to support the maximum loads shown. Exceeding these load limits could cause sagging, instability, collapse, and serious injury.

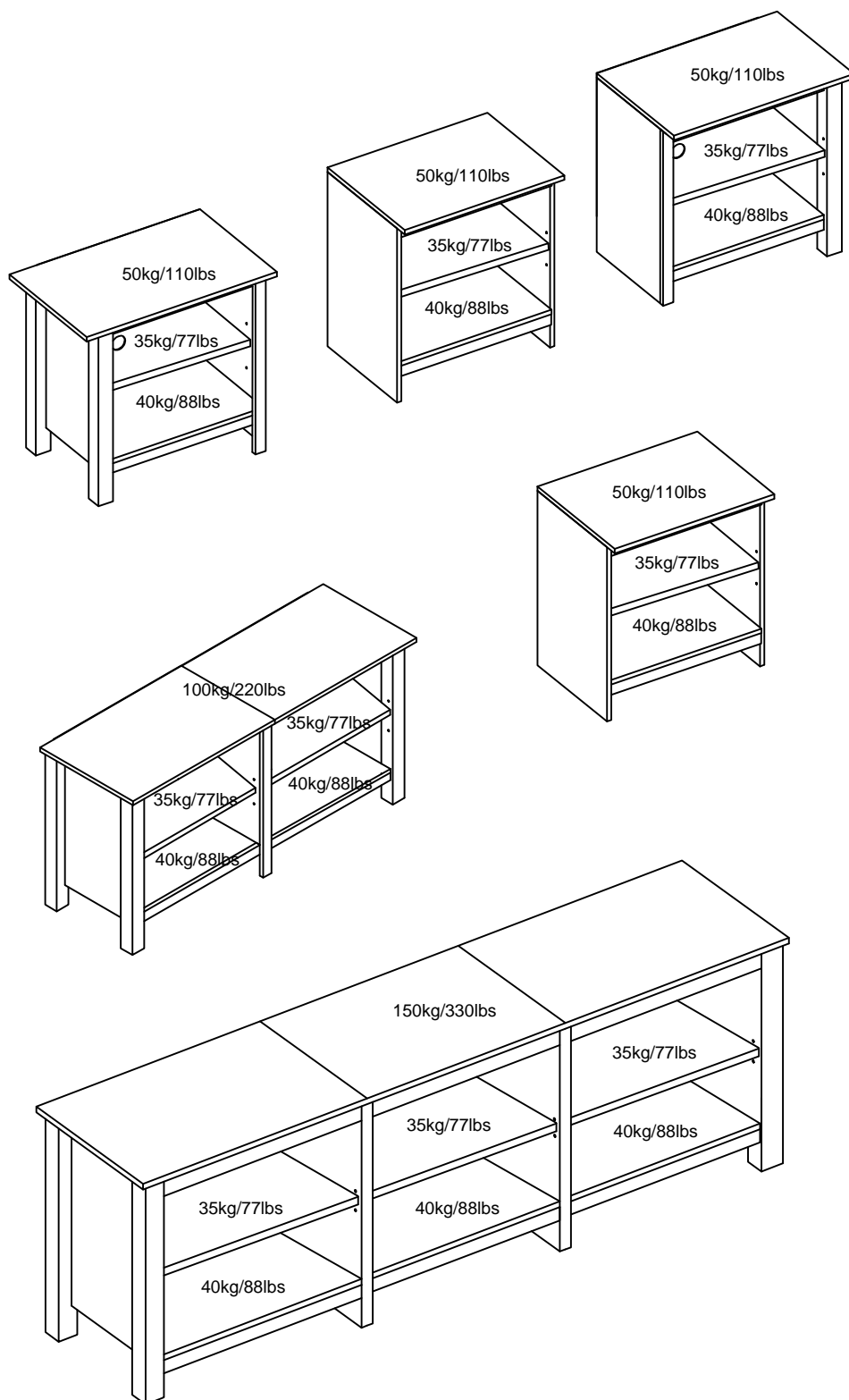

**Your assembly should now be complete.
Thank you for your purchase.**

"KEEP THESE INSTRUCTIONS FOR FURTHER REFERENCE"